

**ARCHAEOLOGICAL  
MONITORING AND IMPACT  
ASSESSMENT COMPONENT OF  
THE FORKS HERITAGE PLAZA  
PROJECT**

Submitted to

**THE FORKS RENEWAL CORPORATION**

**QUATERNARY  
CONSULTANTS  
LIMITED**

November, 1993

## EXECUTIVE SUMMARY

An archaeological resource management program was undertaken as part of the development of The Forks Heritage Plaza. The program consisted of three monitoring components and an impact assessment. The monitoring components were:

- a. monitoring of soil test augering, with archaeological investigation of the drilling tailings;
- b. monitoring the augering of a manhole and lamp standard bore holes in the northern portion of the plaza; and
- c. continual monitoring of the installation of a land drainage sewer line from the B&B Building to the manhole near the centre of the proposed orrery.

No cultural material was encountered during the soil test augering or the augering in the northern portion of the plaza. A deposit of faunal material, identified as bison, was recovered during the monitoring of the land drainage line.

The impact assessment, in the southern portion of the plaza, consisted of mechanized excavation of two trenches, each thirty meters long. The trenches were oriented perpendicular to each other and crossed at the centre of the proposed orrery.

The impact assessment encountered recent disturbance in portions of the impact zone, relating to railroad installations of water and sewer lines. In undisturbed areas, the soil strata were intact and represented three distinct historic periods: the Railroad Period (1888 - 1988); the Railroad Development Period (1885 -1889); and the Hudson's Bay Company Experimental Farm Period (1836 -1848). No evidence of Pre-Contact occupations was encountered in the assessment trenches, indicating that extensive occupation sites (such as the Archaic horizon) do not extend into this area. The absence of archaeological material within the relatively narrow assessment trenches does not preclude the presence of small occupation sites or activity areas associated with the archaeological horizons that occur on the periphery of the proposed orrery.

Archaeological monitoring of all excavation which extends below the railroad cinder deposits (approximately one meter) is strongly recommended.

**TABLE OF CONTENTS**

EXECUTIVE SUMMARY . . . . . i

TABLE OF CONTENTS . . . . . ii

LIST OF APPENDICES . . . . . ii

LIST OF FIGURES . . . . . iii

LIST OF TABLES . . . . . iii

1.0 INTRODUCTION . . . . . 1

    1.1 Study Team. . . . . 1

2.0 MONITORING OF SOIL TEST DRILLING . . . . . 3

    2.1 Observations . . . . . 3

3.0 ASSESSMENT EXCAVATION . . . . . 6

    3.1 Excavation Methodology . . . . . 6

    3.2 Laboratory Procedures . . . . . 8

    3.3 Artifact Description . . . . . 8

        3.3.1 Railroad Horizon (Zone 1) . . . . . 9

        3.3.2 Clay Fill Horizon (Zone 2) . . . . . 12

        3.3.3 Experimental Farm Plow Zone (Zone 3) . . . . . 15

        3.3.4 Recent Watermain Fill Deposits (Zone 4) . . . . . 16

    3.4 Stratigraphy . . . . . 17

    3.5 Discussion . . . . . 21

    3.6 Recommendation . . . . . 23

4.0 MONITORING OF THE COBBLESTONE COURT . . . . . 24

5.0 MONITORING OF THE ORRERY LAND DRAINAGE LINE . . . . . 25

6.0 BIBLIOGRAPHY . . . . . 27

**LIST OF APPENDICES**

APPENDIX A: Heritage Permits . . . . . 30

APPENDIX B: Catalogue of Artifacts . . . . . 39

**LIST OF TABLES**

1: Mammal Remains From the Clay Fill Horizon (Zone 2) . . . . . 14  
2: Mammal Remains From the Plow Zone Horizon (Zone 3) . . . . . 16

**LIST OF FIGURES**

1: Map of The Forks Heritage Plaza . . . . . 2  
2: Location of Soil Test Auger Bore Holes . . . . . 4  
3: Location of Impact Assessment Trenches . . . . . 7  
4: Stratigraphic Profile of North/South Trench . . . . . 18  
5: Stratigraphic Profile of East/West Trench . . . . . 19  
6: Location of Assessment Trenches and Prior Disturbances . . . . . 22  
7: Location of Plaza Manhole and Lamp Standards . . . . . 24  
8: Field Sketch of Bone Bed . . . . . 26

## 1.0 Introduction

Development of The Forks Heritage Plaza is a phased project with two components - a cobblestone-paved courtyard and traffic area in the northern portion and a shallow, bowl-shaped orrery in the southern portion (Figure 1). As the proposed plans include sub-surface components, it is possible that archaeological resources may be impacted. Archaeological investigations have occurred on the northern, southern, and western peripheries of the plaza area. During the Stage I construction project, several cultural strata were recorded along Forks Market Road (Kroker and Goundry 1990). At the North Point Node in The Forks National Historic Site, several Pre-Contact occupation horizons were recorded (Adams *et al.* 1990). During the North Assiniboine Node Assessment to the west, evidence of the Hudson's Bay Company flour mill, a Woodland ceramic occupation horizon, and the extensive Archaic (3000 year old) occupation were recorded (Kroker 1989). Extensions of the Archaic horizon were investigated in conjunction with the Assiniboine Riverfront Quay Project (Kroker and Goundry 1993a), and the 1992 Public Archaeology Project (Kroker and Goundry 1993b). No testing or investigation has occurred to date within the defined plaza area.

In order to redress this dearth of knowledge, an archaeological resource management program was initiated. The first investigation was archaeological monitoring of the soil test drill holes undertaken by HBT AGRA Limited. The second operation consisted of archaeological impact assessment trenching in the southern portion of the plaza where impact below the rail cinder horizon could be anticipated. A third archaeological operation consisted of monitoring the excavation of a manhole and five lamp standard sites in the northwest portion of the plaza. The final operations related to the plaza consisted of monitoring land drainage (storm sewer) line excavations from the proposed orrery to the land drainage lines installed for the Children's Museum.

All four operations were approved by, and conducted under, Heritage Permits (Appendix A) issued by Historic Resources Branch, Department of Culture, Heritage and Citizenship. The relevant permits are A23-93 [soil test monitoring], A28-93 [impact assessment], A33-93 [manhole and lamp standard monitoring], and A34-93 [land drainage sewer line monitoring]. All projects were undertaken by Quaternary Consultants Ltd. and directed by Sid Kroker.

### 1.1 Study Team

The initial operation, soil test monitoring, was conducted by Sid Kroker. The impact assessment excavations were directed by Sid Kroker and employed Barry Greco, Paul Speidel, Geoff Marr, Eric Simonds, and Lee-Anna Smith. The backhoe was operated by Raymond Demarcke. The lamp standard monitoring was undertaken by Sid Kroker. The construction monitoring of the land drainage sewer line was conducted by Steve Lundin and Pat Carroll.

Laboratory operations, resulting from artifact recovery, were supervised by Pam Goundry. Barry Greco, Paul Speidel, Geoff Marr, and Pat Carroll processed the material. Computer cataloguing was completed by Pam Goundry. Documentation and analysis has been undertaken by Sid Kroker and Pam Goundry.

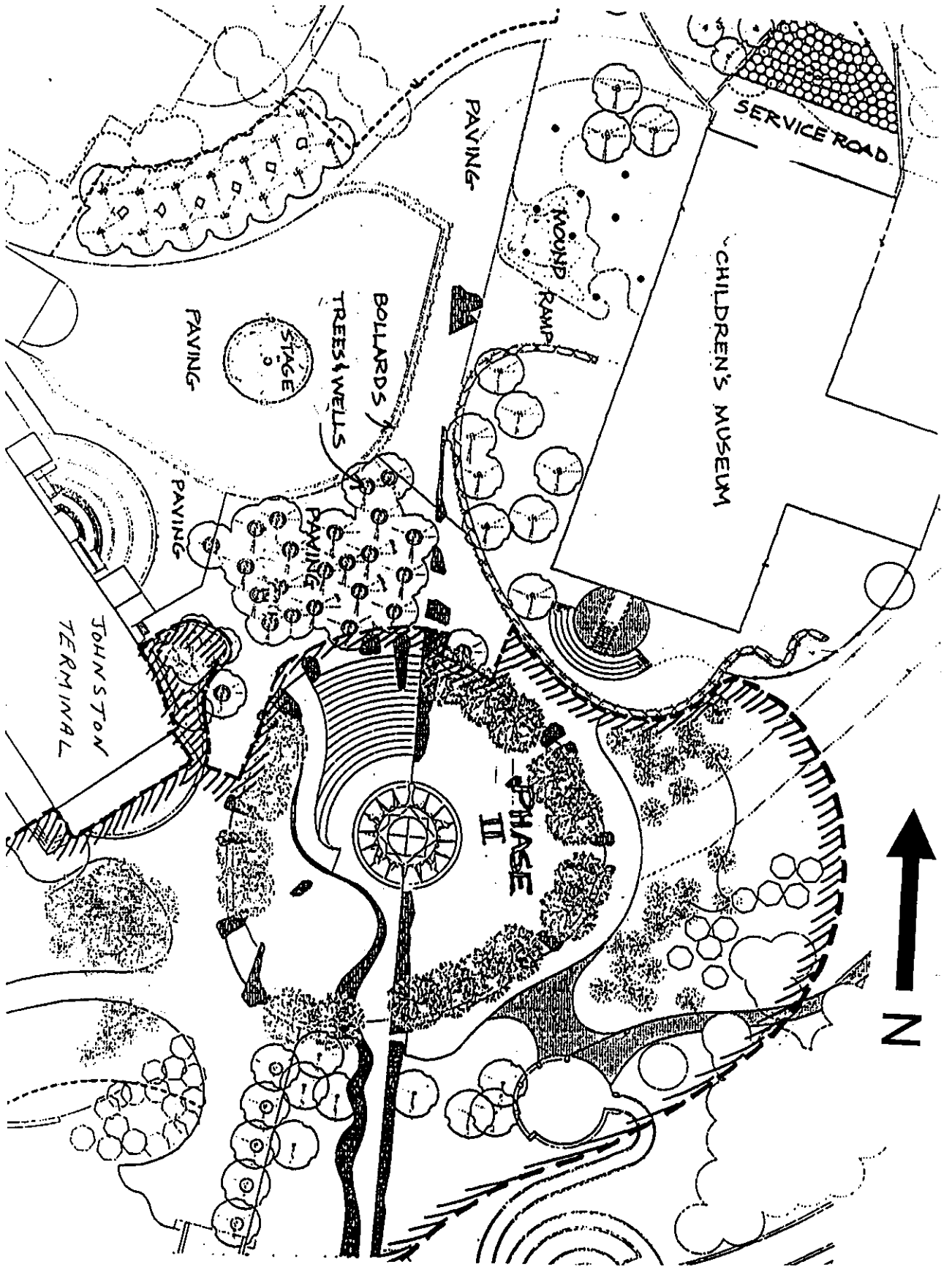

Figure 1: Map of The Forks Heritage Plaza

## 2.0 Monitoring of Soil Test Drilling

The soil test operations were conducted by HBT AGRA Ltd., utilizing the services of Paddock Drilling. A total of nine test holes were drilled within the projected impact area (Figure 2). Six holes were drilled to a depth of three meters, two holes to nine meters, and the final hole was drilled to auger refusal at 15.2 meters (HBT AGRA 1993:1).

Archaeological investigations consisted of visual inspection of the disturbed soil column observed from the auger cuttings and visual inspection of the undisturbed soil column samples retrieved from split-spoon samplers. These are tubular coring devices which are pushed into the undisturbed sediments at the base of the hole and the soil column is retrieved intact and can be examined when the tube is separated into the two vertical halves. Inasmuch as the soil strata at The Forks consist of riverine sediments, there is a considerable variation in thickness and/or presence across short distances. A similar situation can occur with regard to archaeological deposits - occupational evidence may be localized or fairly widespread.

Given the plasticity of the soil and the resultant deformation of the soil column by the 4" auger, only thick (more than 2 cm) cultural layers are readily observable. Thin horizons tend to become 'smeared' and, if observable, cannot be accurately placed in vertical context. The exceptions to this general rule are those which are noted within the split-spoon samples.

### 2.1 Observations

Test Hole 1 extended to a depth of three meters. Slight 'smears' were noted within the upper clay horizon (0.8-1.8 m). The discolourations would indicate relict soil horizons, but no cultural evidence was present. Another 'smear' was observed at 2.6 meters, again with no cultural evidence.

Test Hole 2 consisted of fill to 1.5 meters with clay to base at 2.4 meters. No relict horizons were recorded.

Test Hole 3 extended to a depth of 3 meters. Railroad fill and a thick sand horizon extended to 1.1 meters. The clay below had a minor 'smear' between 2.5 and 2.7 meters.

Test Hole 4 extended to a depth of 3 meters. The upper 1.3 meters was cinder/gravel fill with discoloured clay below. No relict horizons were observed.

Test Hole 5 consisted of fill, primarily sand and disturbed clay, to a depth of 2.2 meters. The remaining natural deposits to termination at 3.0 meters were clay with traces of charcoal at 2.5 meters.

Test Hole 6 extended to a depth of 3.0 meters. The upper 1.2 meters were railroad cinder fill with underlying silty clay and sandy silt strata. No evidence of relict soils was noted.

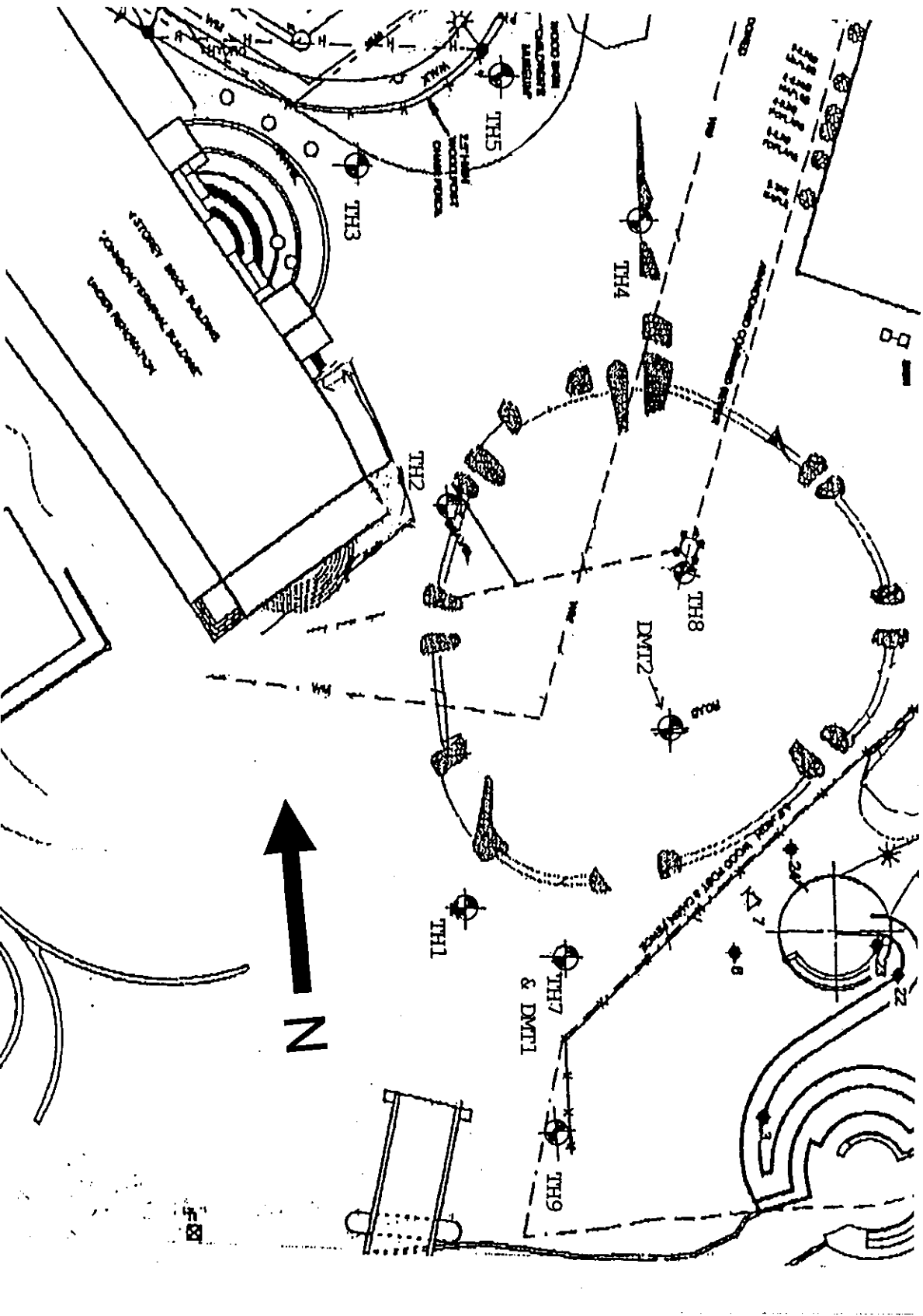

Figure 2: Location of Soil Test Auger Bore Holes (from HBT AGRA 1993)



Test Hole 7 extended to a depth of 15.2 meters. Cinder fill comprised the upper 1.3 meters with natural deposits below that. A fragment of charred timber was recovered from the auger cuttings at an estimated depth of 1.3-1.35 meters. A thin organic horizon was noted at 1.6 meters. No cultural material was associated with this horizon. Archaeological monitoring ceased when Lake Agassiz clays were encountered at a depth of 11.8 meters.

Test Hole 8 extended to a depth of 9.2 meters. Natural sediments were encountered at a depth of 1.2 meters. Slight evidence of relict soil horizons were observed at 1.4 meters, 2.5 meters, and 3.2 meters. No cultural material was evident.

Test Hole 9 was drilled to a depth of 9.2 meters. Alternating clay and sand horizons underlay the upper 1.5 meters of cinder fill. No definitive evidence, in the form of cultural material or horizon 'smears' were observed in the auger cuttings.

### 3.0 Assessment Excavation

To obtain information across this large area, two perpendicular linear trenches (Figure 3), which crossed at the centre of the proposed plaza location, were excavated. These trenches were each 30 meters long. The excavations were to a minimum depth of two meters. At selected locations, the excavations extended beyond three meters.

The centre of the trenches is located at 1065N/982W, based upon The Forks Archaeological Survey Grid which uses the City of Winnipeg survey marker (87R548), at the north end of the Low Line Bridge, as the Site Datum. This marker has been assigned the arbitrary provenience of 1000N/1000W. The 1000E/W Baseline extends from the marker to the second concrete pier (to the south of the embankment) of the CNR Main Line Bridge.

The primary focus of the impact assessment was the determination of the number of cultural horizons as well as the extent of each of these horizons. Artifacts were retrieved and analyzed to provide temporal and cultural data.

#### 3.1 Excavation Methodology

Due to the large area and the considerable depths to be investigated, the primary excavation tool was a rubbermount backhoe with an 18" bucket. To prevent disturbance of the soils below the level of the excavation, a smooth steel plate was welded to the teeth of the bucket.

The trenches were sub-divided into 5.0 meter units for horizontal provenience control. Occasionally, due to topography or other factors, the units were smaller. Vertical provenience was maintained by ensuring that the backhoe bucket took horizontal cuts, within the 5-meter unit. Each cut was generally 5 cm thick. Thicker cuts were made in archaeologically sterile strata. The recorded stratigraphy was based upon natural strata. These strata are designated within the generalized Forks horizons (Kroeker 1989).

- Level 1: Railroad fill strata (ca. A.D. 1885 to present)
- Level 2: Historic strata (A.D. 1738 to 1885)
- Level 3: Native Ceramic strata (ca. A.D. 1 to 1738)
- Level 4: Pre-Ceramic Archaic strata (ca. 3000 B.C. - A.D. 1)

Stratigraphic profiles were recorded at relevant locations along each trench. The procedure involved examination of the trench wall and recording the thicknesses of each stratum (cultural horizon, fluvial deposit, relict soil zone, etc.).

The excavated soil was brought to the surface by the backhoe and spread across the ground adjacent to the trench. The field crew, using garden rakes, spread and sorted through the excavated soil. Recovery techniques also included the use of trowels and hand-retrieval. All artifacts were bagged

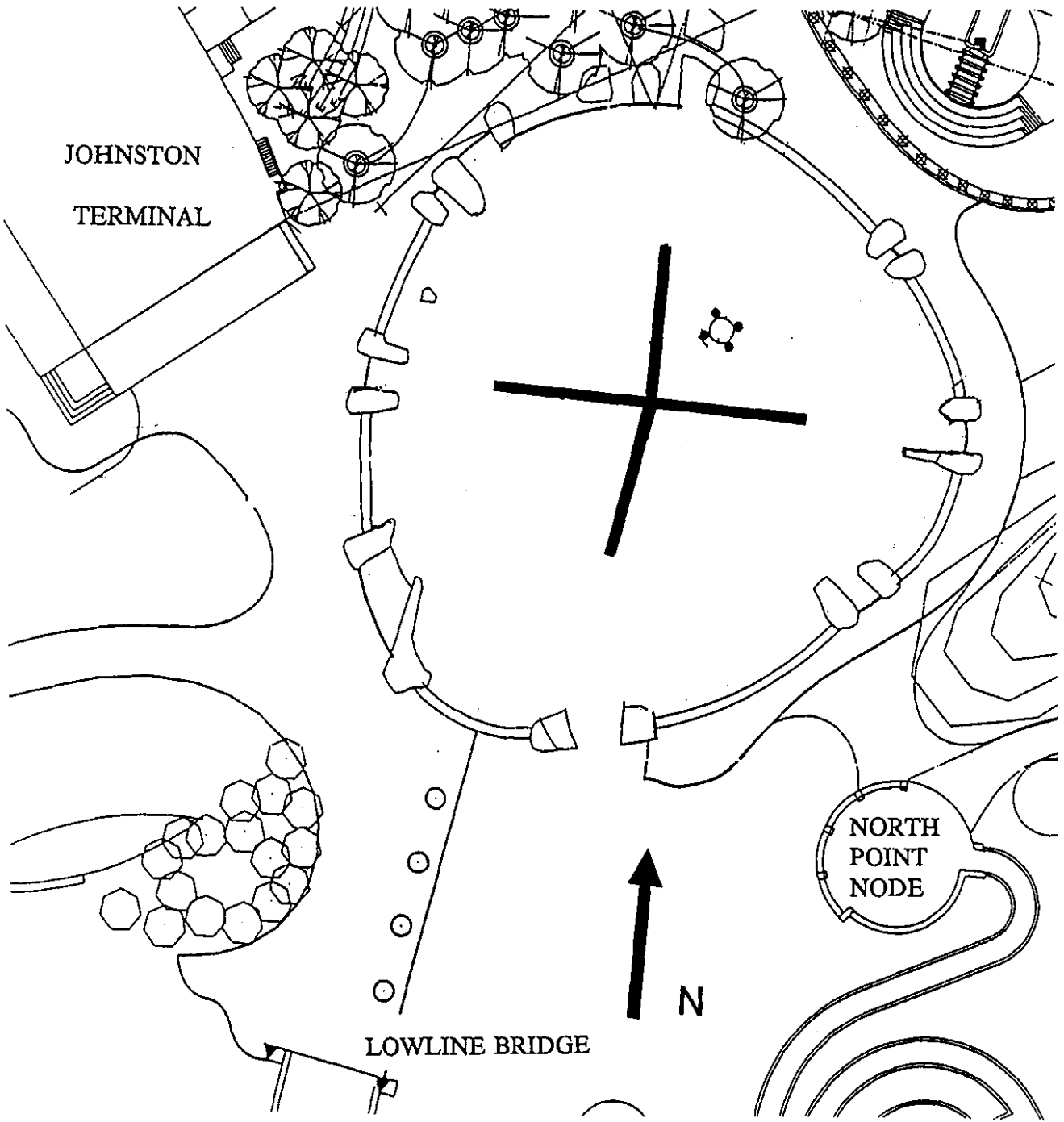

Figure 3: Location of Impact Assessment Trenches

according to horizontal provenience and excavation level. The recovery of small items such as fish scales and vertebrae validates this investigation technique.

### ***3.2 Laboratory Procedures***

The recovered artifacts were brought to the laboratory facilities, where they were washed and sorted by material class. After the specimens had dried, all artifacts were identified by the lab personnel. Material of the same type (i.e., white porcelain saucer sherd with a green geometric pattern) within the same excavation unit and level were combined under a single catalogue number. Identification was carried to the limit obtainable by available reference works and staff expertise. Faunal remains were, where possible, identified to element and species.

Each sequential catalogue number consists of the Borden designation for The Forks (DILg-33), followed by the project designator (93B - indicating the second project of 1993 on the site) and the specimen number (e.g., DILg-33:93B/1). All pertinent data associated with the artifact was entered into the computer cataloguing system. The cataloguing system is based upon the Canadian Heritage Inventory Network (CHIN) system (Manitoba Museum of Man and Nature 1986; FRC 1988:110, 171; Kroker and Goundry 1993a:Appendix B). The computer cataloguing program was developed by Brian Lenius, based upon **DBASE3**, for use on personal computers. The project used an IBM AT clone computer with a 40 megabyte hard drive and a dot matrix printer for the generation of individual artifact catalogue cards on fanfold 3" x 5" cards.

Processed artifacts were prepared for storage by inserting the specimens and the catalogue card into standard plastic storage bags, then stapling the bags closed. At the end of the project, all recovered artifacts will be delivered to the designated repository (FRC 1988).

### ***3.3 Artifact Description***

Artifacts were recovered from three distinct horizontal strata and one intrusive recent activity. All strata are the result of human activity but incorporate artifacts representing secondary deposition. The intrusive deposits are redeposited secondary deposits. While the horizons appeared to be largely intact, frost cracks and rodent disturbance (tunnels, burrowing, etc.) can result in the presence of later period artifacts in earlier sedimentary strata, e.g., recent extruded nails being recovered from Fur Trade horizons. Intrusive specimens were catalogued according to the stratum from which they were recovered.

The artifacts consist of glass, metal, and ceramic objects with some faunal remains. The cataloguing system is based upon a functional hierarchy and specimens will be discussed within broad groupings. Unless the artifact is diagnostic and/or discussed in detail, catalogue numbers are not included in the text. The entire catalogue of recovered artifacts is attached as Appendix B.

### *3.3.1 Railroad Horizon (Zone 1)*

The railroad stratum consisted of layers and lenses of black coal cinders, sands, and gravels containing historic artifacts. Based upon its stratigraphic location, it would appear to represent relatively recent deposition and elevation raising activities undertaken by the various railroad companies after the beginning of the 20th century.

A total of 313 specimens were recovered from this horizon. These included artifacts representing the broad categories of Transportation, Architectural Object, Communication, Lighting, Clothing, Recreation, Food Processing, Detritus, Container, and Faunal Remains.

Transportation-related artifacts consist of two railroad spikes, one O-ring, five aqua glass water gauge tube fragments, and four sherds of red glass deriving from signalman's lanterns. The O-ring (DILg-33:93B/296), composed of hard rubber, functioned as a seal for the steam line couplers between railroad cars (Kroker 1989:48). The degree of opacity of the red glass sherds indicate at least two sources: three sherds (DILg-33:93B/42, 168, 250) are translucent medium red and the fourth (DILg-33:93B/78) is almost opaque dark red.

The Architectural Objects consist of fourteen nails, 101 windowpane sherds, two porcelain sherds from bathroom fixtures, a fragment of a glass brick, and a fragment of a glass knob from a cupboard door. The nails are a mixture of extruded round nails (5) and sheet-cut specimens (9). Three of the sheet-cut nails have T-heads, one has an L-head, and the remainder are not identifiable. Lengths of complete specimens range from 54 to 129 mm (2" - 5"). The windowpane sherds are predominately aqua, except for one thin sherd (DILg-33:93B/10) which is translucent emerald green and four sherds which are clear. Thicknesses range from 2.5 to 7.9 mm. One aqua windowpane sherd (DILg-33:93B/207) has traces of an etched geometric design. The bathroom fixture sherds (DILg-33:93B/199, 273) are slightly curved, glazed, white coarse paste specimens. The pale purple glass brick is 29.5 mm thick and square in cross-section (DILg-33:93B/85). The face is recessed and remnants of a border lip exist. The cupboard knob sherd (DILg-33:93B/79) is half of a domed, circular deep purple specimen, 29 mm in diameter and 9.9 mm high.

Telecommunication artifacts consist of six fragments of aqua telegraph insulators representing a minimum of three specimens. Only one, DILg-33:93B/307, has any identifying marks - the embossed word "STANDARD".

Two specimens belong in the Lighting category. These include a porcelain and copper socket fragment with some attached wiring (DILg-33:93B/80). The information "250V" and part of a serial number "...47065" are embossed on this artifact. The second specimen, DILg-33:93B/81, is the copper base of a light bulb.

Two artifacts belong to the Clothing category. The first is a plain, white, four-hole plastic button (DILg-33:93B/82) and the second is a portion of a leather shoe (DILg-33:93B/129). An unmarked, black bakelite pipestem (DILg-33:93B/4) was assigned to the Recreation category.

Two other artifacts represent Food Processing. These include a corroded, incomplete knife blade (DILg-33:93B/211) which is 23.7 mm wide and 2.3 mm thick. A more recent fork, DILg-33:93B/5, was also recovered. This specimen is embossed with the trade name "MINUET STAINLESS" and the country of manufacture "HONG KONG". A scroll-like impressed design occurs on the perimeter of the handle.

While most unidentifiable fragments were not curated, some specimens of Detritus were retained. These consist of one copper fragment, one flat iron fragment, one angle iron fragment, three bakelite fragments, one tin sheet fragment, and one lead sheet fragment.

Glass sherds from storage Containers, i.e., bottles and jars, were one of the more prevalent recoveries. Specimens occurred in several colours and will be discussed within colour groups.

Nine sherds are olive. One specimen (DILg-33:93B/3) has the vertically striated flat side of a case gin bottle. Another sherd (DILg-33:93B/319) is the lip, collar, neck portion of a liquor bottle, which has an applied stopper finish with a V-shaped string rim surmounting a bulged neck (Jones and Sullivan 1985:89-97). The remaining specimens are round body or neck sherds.

The three amethyst sherds consist of one basal fragment (DILg-33:93B/35) and two ground lip sherds (DILg-33:93B/204, 253). The lip sherds represent a wide-mouthed, short-necked bottle. The two green specimens are a pale green basal sherd (DILg-33:93B/212) from a rectangular bottle and a dark, almost opaque body, base sherd (DILg-33:93B/318) from a circular liquor bottle.

One multi-coloured sherd (DILg-33:93B/257), consisting of a red and white painted pattern on clear glass, derives from a Pepsi-Cola bottle. The text "...I COLA" is also embossed on the sherd.

One sherd of translucent, milky white glass, DILg-33:93B/20, appears to represent a bottle. The glass of the twelve other white sherds have the density and appearance of cosmetic jars. No specimens are diagnostic, although one sherd (DILg-33:93B/21) is a lip, body fragment which indicates that it would be closed with an outer ring lid.

Brown glass consisted of one complete bottle (DILg-33:93B/317) and nine sherds. The bottle was produced by McDonagh & Shea (Type MWIN BC6 Chopping 1978:137). One sherd (DILg-33:93B/148) is the lip, neck, shoulder sherd from a small flask-type bottle and three other sherds (DILg-33:93B/315) are the oval edge of a larger flask-type bottle. The remaining sherds are undiagnostic body or base sherds.

A total of 22 aqua glass sherds were recovered. Thirteen are undiagnostic body or neck sherds. Three specimens have an intact lip and finish. One, DILg-33:93B/275, is the bulbous rounded finish of a Hutchinson stopper type, although the remnant of the neck appears more elongate than usual. A second has a flat patent lip (DILg-33:93B/202). The third (DILg-33:93B/256) has a flat, two-part stopper finish applied to a short neck, surmounting a flask-shaped body. Four sherds have embossing. The numbers "6-9", in a very small font, are located just above the base junction of one sherd (DILg-33:93B/314). The text, "E.L.DREWR..." is embossed on a shoulder sherd (DILg-

33:93B/94), identifying the bottle as a product of Drewry Brewery, albeit not identifiable to a Chopping Type. A body,base sherd (DILg-33:93B/93) has "...UR PROPERTY/...EREFOR" embossed on the side and "...WR..." embossed on the base, again identifying a Drewry product. A small base sherd (DILg-33:93B/41) has the embossed letters "DR..." and represents another Drewry bottle.

A total of 35 clear glass sherds were curated. Twenty-four are plain body sherds, two of which are partially melted. Only a few specimens had markings and/or characteristic features which would permit determination of function. Three specimens appear to be portions of milk bottles as indicated by vertical panels (DILg-33:93B/293), a recessed lip of a large milk bottle (DILg-33:93B/290), and embossing on wide vertical panels (DILg-33:93B/77). The latter sherd has a lower case script "...NT" embossed on a wide-panelled surface, indicating that it represents a different milk bottle than the earlier noted sherds (DILg-33:93B/293 and 290), which have narrow panels. The other functionally ascribable artifacts are DILg-33:93B/75, a crown lip from a carbonated beverage bottle, and DILg-33:93B/322, a partially melted, thick-walled body sherd which has "INKS" embossed horizontally on it in large print, indicating the contents.

Some clear specimens could be identified to type, including a vertical ground lip from a wide-mouth jar (DILg-33:93B/95), a flat, two-part stopper finish (DILg-33:93B/320) identical to a similar aqua specimen, and a rounded applied single ring lip (DILg-33:93B/321). Manufacturing technology could be discerned from a basal sherd (DILg-33:93B/294) from a large bottle which shows evidence of two-piece post mold. In addition to the aforementioned milk bottle sherds, a decorative molding pattern of horizontal ribs was evident on DILg-33:93B/323. Locations of manufacture could be determined from two specimens: the embossed milk bottle sherd (DILg-33:93B/77) which derives from the Crescent Dairy in Winnipeg and a neck,shoulder sherd (DILg-33:93B/17) which has "...E IN U...", possibly a reference to the United States.

Two distinct sherds were assigned to the ornamental Container category. One sherd, DILg-33:93B/206, is from a blue fluted bowl and the other sherd (DILg-33:93B/98) derives from a bowl decorated with pale blue raised ribs on a yellowish-green background.

Stoneware storage containers are represented by nine sherds. A brown body,base sherd (DILg-33:93B/194) is part of a stoneware bottle. One yellow sherd (DILg-33:93B/156) and three grey sherds (DILg-33:93B/8, 312) represent at least three different crocks, while four sherds (DILg-33:93B/247, 311) come from two-tone brown and grey coloured jugs.

A total of 37 porcelain dinnerware sherds were recovered. The preponderance (23) are plain, undecorated white sherds deriving from bowls, cups, plates, and saucers. One lip,body sherd from a plate (DILg-33:93B/159) has a trace of an embossed pattern and four lip,body sherds from a cup (DILg-33:93B/221) have a 'wheat' pattern embossed below the lip above a wide-ribbed body. This pattern most closely resembles an illustration of the wheat pattern produced by Robert Cochran (1863-1896) (Sussman 1985:20-21). One sherd, DILg-33:93B/157, has a thin painted gold line on the lip and derives from a cup. Two sherds from a bowl? have portions of a red floral design on the body (DILg-33:93B/84, 158) with a red line below the lip on one of the sherds. A body sherd,

DILg-33:93B/12, has the painted green lines previously identified as representing the Canadian Northern railway (Kroker and Goundry 1993a:162). A hip, body, base sherd (DILg-33:93B/83) from a shallow bowl has a green exterior and a white interior and base. One blue-on-white body sherd from a saucer (DILg-33:93B/274) has a portion of an Oriental design. The second blue-on-white sherd, DILg-33:93B/13, derives from a plate and has the blue lines which identify it as Canadian Northern Railroad dinnerware (Kroker and Goundry 1993a:94). An ornate blue-on-white sherd from a saucer (DILg-33:93B/313) has applique gold outlining the design. This pattern may have originally been multicoloured but exposure to fire has caused the sherd to discolour. A thick body sherd from a bowl (DILg-33:93B/22) is grey-brown with red, all of which may be the result of chemical or thermal alteration to an originally white specimen.

The faunal recoveries from this horizon consist of three fragments of freshwater clam (Unionidae) shell (DILg-33:93B/11, 87, 88), one vertebral process (DILg-33:93B/89) and five long bone fragments (DILg-33:93B/90, 137) from large mammal, and six specimens deriving from Artiodactyla. The artiodactyl specimens include two skull fragments (DILg-33:93B/91), one ulnar carpus (DILg-33:93B/101), a sawn section of femur (DILg-33:93B/136), and a cut-marked vertebral process (DILg-33:93B/210) from an adult cow, as well as one sacrum fragment (DILg-33:93B/92) from an immature individual.

### 3.3.2 Clay Fill Horizon (Zone 2)

The clay fill stratum consisted primarily of a grey-brown clayey silt containing historic artifacts. Based upon its stratigraphic location, it would appear to represent initial land modification activities undertaken by the Northern Pacific and Manitoba Railroad during 1888 and 1889. After the purchase of land from the Hudson's Bay Company, the railroad erected the Engine Repair Facility (now known as the B&B Building) and Roundhouse. Track was laid to this building as well as to the depot at the junction of Water and Main. Guinn (1980:140) notes that considerable land modification, i.e., grading and gravel filling, took place.

Most rivers have an elevated natural levee at the edge of their banks and the Assiniboine was probably not an exception. Levelling the riverbank area would have redeposited the levee sediments into the interior of the East Yard area. Artifacts would have been displaced along with the soils.

This horizon yielded 159 artifacts representing the broad categories of Architectural Object, Clothing, Recreation, Container, and Faunal Remains. The nineteen Architectural Objects include nails, windowpane, iron strapping, and sewer tile. The four nails are identified as a rose-head sheet-cut nail, a hand-wrought brad, and two headless hand-wrought nails. There are ten specimens of aqua windowpane of varying thicknesses, only one of which is thick enough to be plate glass (DILg-33:93B/280). Three sections of corroded, rolled iron strapping, one fragment of corroded iron scrap, and a fragment of terracotta sewer tile (DILg-33:93B/181) were curated.

The Clothing category was represented by one severely corroded and friable copper shank button (DILg-33:93B/224). Recreational activities were represented by a small portion of a kaolin pipestem (DILg-33:93B/179). There were no markings on the stem to identify a manufacturer.



Containers were strongly represented with 96 sherds representing storage and dinnerware sub-categories. Most of the specimens ascribed to the storage sub-category were made of glass, although one sherd of glazed terracotta deriving from a flowerpot (DILg-33:93B/226) falls within this grouping. The glass sherds are various colours: white (3), dark olive (2), light olive (1), green (1), amethyst (1), brown (1), aqua (12), and clear (11). Minimal diagnostic evidence was present to ascertain type of bottle or temporal period of manufacture. Two of the clear basal sherds (DILg-33:93B/172, 173) appear to represent square or rectangular medicine bottles. A clear lip sherd, DILg-33:93B/259, has a ground lip and multiple string collar with a constricting neck. The amethyst sherd, DILg-33:93B/327, has a ground lip and a mold seam extending to the top of the short vertical neck.

The 63 dinnerware specimens were all made of porcelain except for a single, pale brown, stoneware sherd from a bowl (DILg-33:93B/177). There are 40 undecorated white sherds, representing plates (3), saucers (3), plate?/saucer? (12), cup (1), bowl? (13), bowl?/cup? (2), and unidentified (6). All sherds were undiagnostic except for two small basal specimens (DILg-33:93B/263) which have portions of a post-1837 British Royal Crest imprinted in black. The fragments are too incomplete to ascertain the manufacturer. According to Kovel (1986:267), in addition to many English companies using variations of the Royal Crest, many potteries in other countries also utilized the crest. Therefore, these sherds cannot be definitely ascribed to an English firm. Five other white sherds have traces of embossed designs, one has a floral pattern (DILg-33:93B/232) while four others have a leaf and hops pattern (DILg-33:93B/184). Two sherds have portions of different red-on-white designs: one is a thin pale red line (DILg-33:93B/174) while the other is a leaf (DILg-33:93B/105). A single sherd, DILg-33:93B/175, has a portion of a green-on-white line drawing of an uninterpretable pattern. Two sherds have portions of purple-on-white designs. One is a plate?/saucer? lip sherd with a line overlying interlocking horizontal "S's" (DILg-33:93B/176). The other is a basal sherd with a vague impression of a stylized butterfly (DILg-33:93B/231). Two yellow and white body sherds appear to derive from the same bowl (DILg-33:93B/107, 284). Ten blue-on-white sherds represent three different patterns: a white honeycomb on a purplish blue band on the interior of a saucer lip (DILg-33:93B/229), a pale blue floral pattern on the interior base of a plate?/saucer? (DILg-33:93B/230), and an indistinct blue pattern on both sides of the body of a plate?/saucer? (DILg-33:93B/300).

The faunal assemblage was dominated by large mammalian bone. These were identified where possible and are listed in Table 1. Most of the 35 specimens were too fragmented to permit identification beyond family. The Leporidae specimen could derive from *Lepus* (jackrabbit) or *Sylvilagus* (snowshoe hare). Pig was the only species that could be positively identified, although most of the Artiodactyla (cow/moose/elk family) specimens probably derive from domestic cow. Based upon the recoveries, at least four individuals are represented - one adult and one immature pig and one adult and one immature Artiodactyla. Given the relocation of the specimens, it is impossible to ascertain whether they represent a single occupation or several. The inclusion of a heavily weathered specimen with others that show minimal evidence of weathering suggests different sources for the material, both temporal and locational. The sawing and the species identification suggests that most of the specimens derive from food processing activities which

occurred after Contact and may relate to the occupation of Fort Gibraltar II (Fort Garry I) after 1817.

In addition to the mammal specimens shell and fish remains were also recovered. Two small valve fragments from freshwater clam (Unionidae) were identified (DILg-33:93B/227). The fish remains consist of a fused dentary/angular (DILg-33:93B/331) and a dorsal spine (DILg-33:93B/332) from a catfish (*Ictalurus* sp.), an operculum unidentified to species (DILg-33:93B/269), and two unidentifiable fragments (DILg-33:93B/270).

TAXON	ELEMENT	CAT.NO.	QTY	COMMENTS
Mammal (Undiff.)	Unidentified	28	1	Calcined
Medium Mammal	Rib	188	1	Sawn
Artiodactyla				
Juvenile	Humerus	287	1	
	Sacrum	267	1	Cut
	Long Bone	334	5	Fragmented
	Long Bone	302	1	
Adult	Vertebra	186	1	Sawn
	Carpus	333	1	
	Innominate	286,266	2	
	Scapula	103	1	Sawn
	Rib	187	1	Sawn
	Rib	102	1	Sawn
	Rib	301	1	
	3rd Phalanx	185	1	
	Long Bone	189	1	
	Long Bone	29	1	Weathered
	Unidentified	335	8	
	Unidentified	336	2	Calcined
	Unidentified	228	1	Charred
Pig ( <i>Sus scrofa</i> )				
Immature	Fibula	268	1	
Adult	Innominate	26	1	Cut Marks
Rabbit (Leporidae)	Femur	27	1	

Table 1: Mammal Remains From the Clay Fill Horizon (Zone 2)

### 3.3.3 Experimental Farm Plow Zone (Zone 3)

The plow zone was continuous across the investigation area except where it had been disrupted by the installation of watermain and sewer lines (pre-1962). The 89 artifacts consist of metal, glass, and ceramic material with the preponderance of recoveries being faunal.

The Architectural Objects consist of three hand-wrought nails and one fragment of chinking. A partially decomposed fragment of a possible post (DILg-33:93B/161) was recovered at 25.00N. The wood has been identified as ash (*Fraxinus* sp.). The top of the post was truncated at the clay horizon immediately overlaying the plow zone. Current interpretation is that the post is part of a fence line which was eradicated during the 1852 or subsequent floods.

Two artifacts catalogued as Recreation items are kaolin pipe stem fragments (DILg-33:93B/120, 236). DILg-33:93B/120 has a portion of the maker's mark, "...N", which may denote Bannerman of Montreal (Kroker *et al.* 1991:113-114). Ceramic containers were represented by two white porcelain sherds (DILg-33:93B/141) with no identifying marks on them, two blue-on-white fragments of an exfoliated plate with an oriental (Blue Willow?) pattern (DILg-33:93B/306), and one blue-on-white cup sherd with an unidentifiable embossed blue pattern (DILg-33:93B/142). Glass containers were represented by one aqua and one white sherd. Both are more than likely intrusive into this horizon.

The majority of the artifacts (75) recovered in the plow zone were faunal with mammalian remains being most strongly represented (Table 2). These consist of fragmented material, some of which show cut marks, saw marks, charring, and/or calcining. Identifications indicated the presence of large Artiodactyla (domestic cattle, bison, or moose), small Artiodactyla (sheep or pig), and undifferentiated large mammal. One specimen (DILg-33:93B/58), the upper front jaw and incisors, could be identified to sheep. The horn core, DILg-33:93B/113, is representative of Bovidae, either bison or domestic cow. Other specimens which could be identified to Artiodactyla include elements of adult large Artiodactyla, juvenile large Artiodactyla, and adult small Artiodactyla (sheep or pig). Adult large artiodactyl elements consist of one fragmented scapula, one molar, one phalanx, one rib, two vertebrae, and eleven carpus/?/tarsus?. Juvenile large artiodactyl specimens include one femur, one humerus, one tibia, and one vertebra. Adult small artiodactyl is represented by one ulna. The undifferentiated specimens of large mammal were identified as three skull fragments, one costal cartilage, nineteen rib fragments, eight long bone fragments, and sixteen unidentifiable fragments.

Other classes of recovered fauna include freshwater clam (one specimen of Unionidae - DILg-33:93B/237), bird (one scapula from a medium sized individual - DILg-33:93B/117), and fish (one preoperculum from an unidentified species - DILg-33:93B/246, and one scute from a sturgeon - DILg-33:93B/140).

TAXON	ELEMENT	CAT.NO.	QTY	COMMENTS
Mammal - large	Costal Cartilage	215	1	
	Skull	114, 163, 243	3	
	Rib	115, 166, 218, 240, 241, 272	19	
	Long Bone	165, 190, 217, 242, 245, 303	8	
	Unidentified	116, 138, 139, 244, 304	16	Calcined, Fragmented
Artiodactyla				
Juvenile - large	Femur	164	1	
	Humerus	112	1	Axe Cut
	Tibia	239	1	Axe Cut
	Vertebra	238	1	
Adult - large	Scapula	192	1	
	Molar	162	1	
	Phalanx	271	1	
	Carpus?/Tarsus?	191	11	
	Vertebra	111, 216	2	Cut, Axe Cut
	Rib	214	1	Cut
Adult - small	Ulna	213	1	Cut marks
Cow Family (Bovidae)	Horn Core	113	1	
Sheep ( <i>Ovis</i> )	Maxilla	58	1	

Table 2: Mammal Remains From the Plow Zone Horizon (Zone 3)

### 3.3.4 Recent Watermain Fill Deposits (Zone 4)

The 67 artifacts within the watermain fill deposits represent material which was initially removed for laying the water pipe and then redeposited into the excavation trench. This operation appears to have taken place after the 1930s and would have resulted in mixing of earlier and later cultural deposits. The artifacts from this zone, therefore, have minimal archaeological value inasmuch as they are removed from even their original secondary context.

Architectural objects consist of thirteen aqua windowpane sherds, one hand-wrought nail, five sheet-cut nails, and an iron rope cleat, DILg-33:93B/70 (cf. Ashdown 1909:371). The nails would have been manufactured in the latter part of the 19th century. No age determinations are available for the other specimens.

Two other metal artifacts were recovered. An unidentified iron handle, DILg-33:93B/33, consisting of a round curved rod with a terminal hook and a proximal grip shaped like a boot last, was recovered from a depth of 198 cm. This specimen probably derives from machinery related to railroad activities or the adjacent Hudson's Bay Company flour mill. The remaining metal object is an iron strap with an attached chain (DILg-33:93B/57) which appears to be the base portion of

a small game trap (cf. Ashdown 1909:555-556). This specimen may date to the Fur Trade period, although it may have been used for rodent control at any time during the Railroad period.

Fragments of ceramic and glass containers were recovered. The eleven ceramic sherds, representing bowls? or saucers?, provided minimal data concerning time period or manufacturer. Seven sherds are white, three consist of blue-on-white patterns (DILg-33:93B/51, 66, 67), and one has a green and red floral pattern on a white background (DILg-33:93B/52). No maker's marks were evident and the sherds were too small to allow pattern identification.

The glass sherds represent varying sizes of bottles of different colours (four clear, one green, one olive, and six aqua). With a few exceptions, the specimens were not ascribable to a manufacturer or type of container. DILg-33:93B/65 is the body, base portion of an E.L. Drewry bottle (Chopping type not determinable). DILg-33:93B/121, a body sherd, has "...RE..." embossed on it. This may also be a Drewry bottle. DILg-33:93B/122 has "TH..." and "WI..." embossed on a body sherd. In all likelihood, this sherd was produced by a Winnipeg firm but the company cannot be identified.

Faunal recoveries consist of only a few specimens. Fish are represented by four unidentified bone fragments plus two samples of scales which had been collected from two small isolated pockets of scale deposits. Large mammal remains consist of two rib fragments and one unidentifiable specimen. A phalanx (DILg-33:93B/54) could be identified as large Artiodactyla and a horn core fragment (DILg-33:93B/72) is from a bovid (cow or bison). A medium to large carnivore is represented by a maxilla fragment with an embedded third molar. The artiodactyl and bovid specimens may represent domestic cattle and the carnivore specimen probably derives from dog.

### ***3.4 Stratigraphy***

Vertical profiles were recorded at numerous locations along each trench. In general, these were taken at 2.5 meter separations. The composite profiles are illustrated in Figure 4 (north/south trench) and Figure 5 (east/west trench).

The upper strata, relating to the railroad period, are generally similar. A sod stratum overlies black cinder fill which in turn overlies an intermediate layer of gravel and sand. A second layer of black railroad cinder deposit, containing historic artifacts extends to a depth of nearly 100 centimeters. Below the second cinder horizon, a layer of light brown sand was present in the east/west trench while an equivalent layer of fine gravel occurred in the north/south trench.

Two extensive pre-rail horizons were evident in both trenches. A relatively thin mixed clay layer occurred at the base of the railroad period deposits. This 'Clay Fill' stratum thickens to the north. It contained a series of artifacts which appear to represent the late 19th century. Given the stratigraphic position of this horizon, it probably relates to the grading and levelling activities of the Northern Pacific and Manitoba Railroad when it began preparing the site in 1888 (Guinn 1980:140). The artifacts may derive from the Fort Gibraltar II/Fort Garry site which is hypothesized to have been situated on the north bank of the Assiniboine River, immediately south of the assessment trenches. This stratum is probably the same as the layer which was encountered

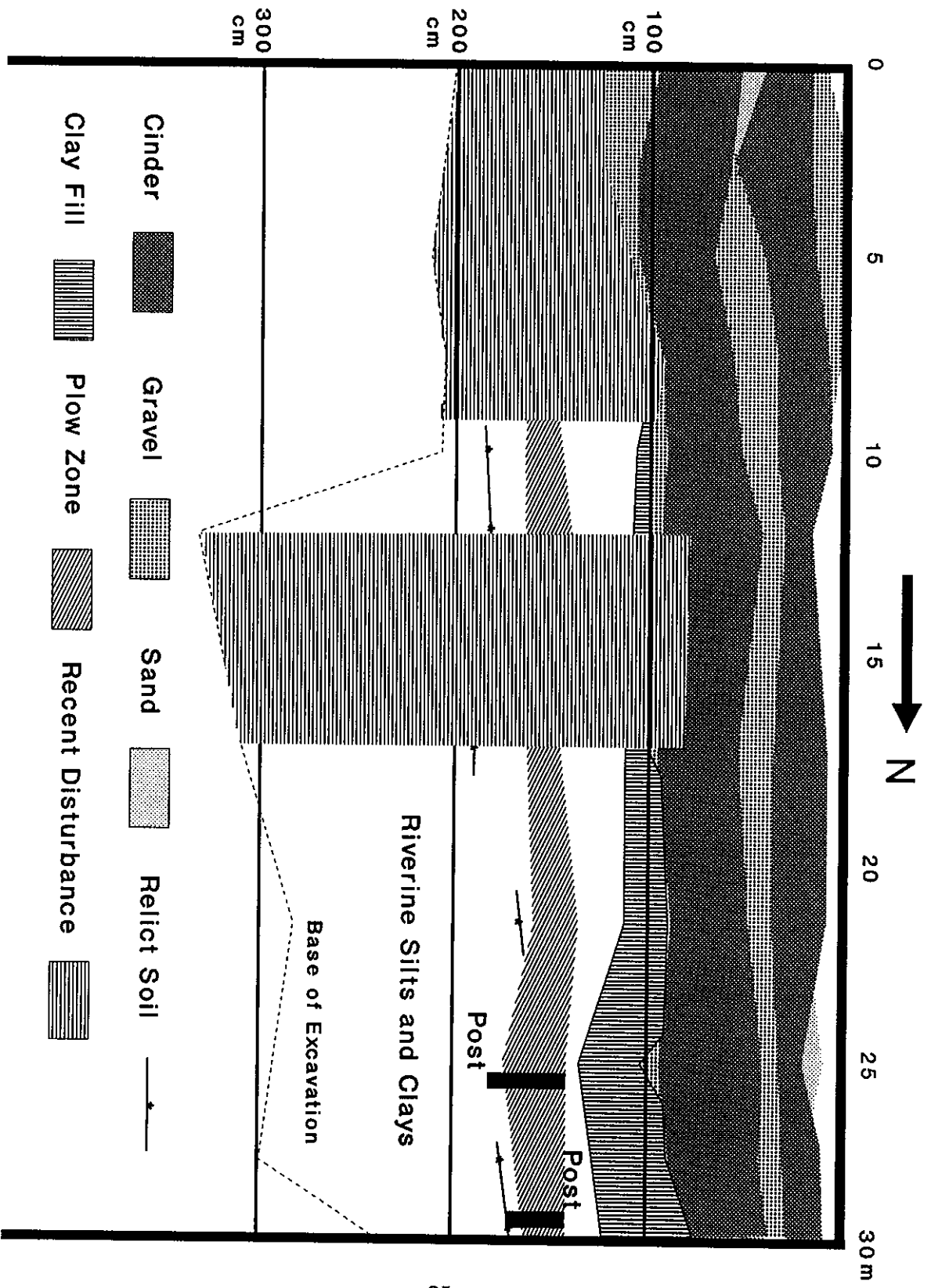

Figure 4: Stratigraphic Profile of North/South Trench

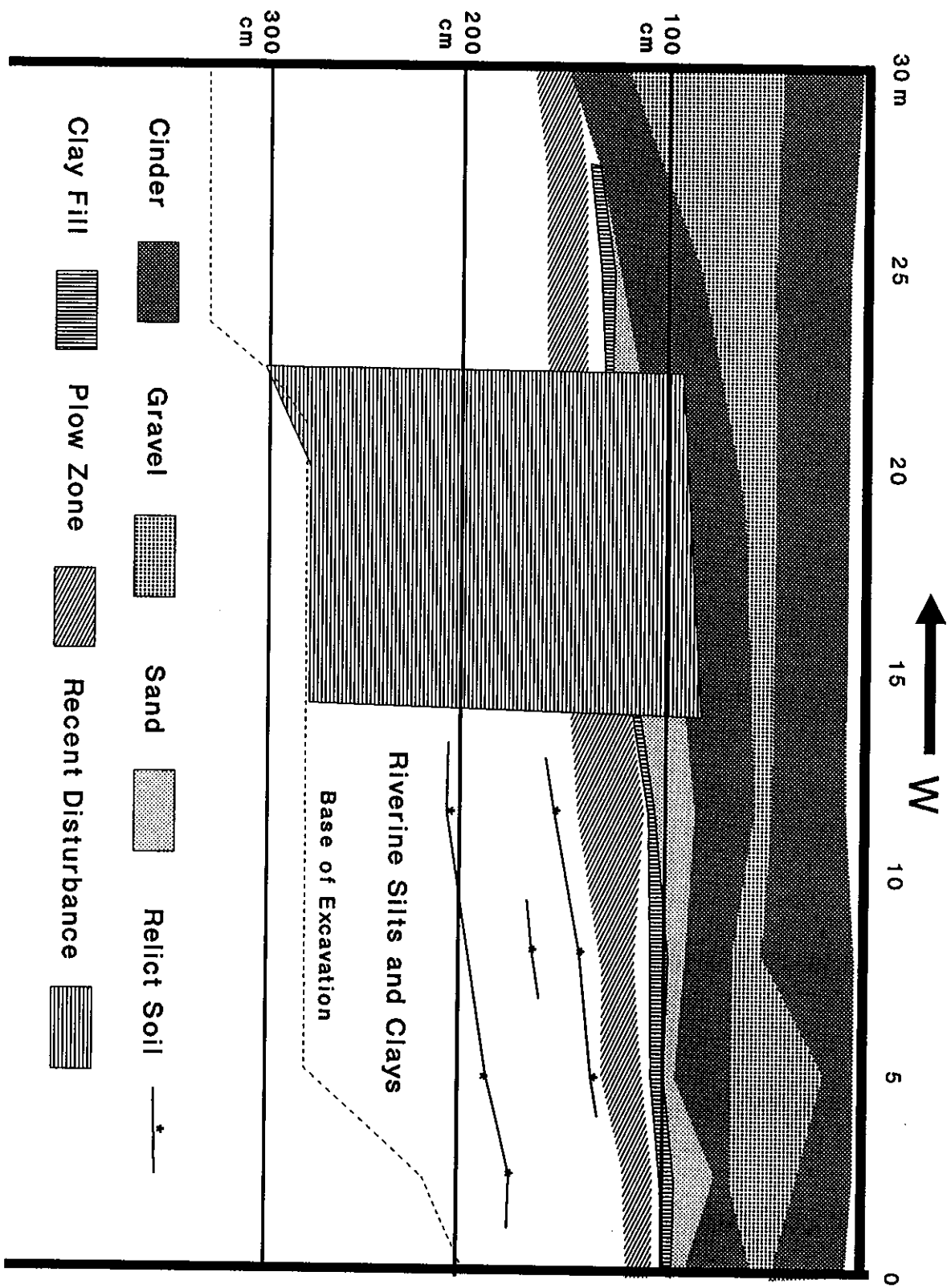

Figure 5: Stratigraphic Profile of East/West Trench

Traces of relict soil horizons were observed in the eastern portion of the east/west trench and in the undisturbed portions of the north/south trench. All of these strata are thin (less than 1 cm) and disjunct. The most extensive relict soil horizon was observed in the east/west trench (Figure 5) at a depth ranging from 180 cm to 205 cm. No cultural material was present in association with any of these disjunct soil horizons and none of the horizons can be confidently linked to other relict soil horizons recorded during other projects. Two distinct, previously known strata were absent: the Double A Horizon (Kroker 1989:Figure 17; Kroker and Gundry 1990:148) and the 750 Year Flood (Kroker and Gundry 1990:143; Kroker and Gundry 1993a:166-167). In addition, none of the relict soil horizons can be correlated with the Pre-Contact ceramic occupations recorded at North Point Node (Adams *et al.* 1990) or Trench 8 of the North Assiniboine Node Assessment (Kroker 1989:150-151), the 2200 year old occupation at Ramp A (Kroker and Gundry 1993a:117-125) and Zone 1 (Kroker and Gundry 1993b), or the 3000 year old Archaic trade centre and campsite (Kroker 1989; Kroker and Gundry 1990; Kroker and Gundry 1993a; Kroker and Gundry 1993b; Quaternary 1993). The most eastern extension of the Archaic horizon has been recorded at Trench 8 of the North Assiniboine Node Assessment (1045N/1017W) (Kroker 1989:Figure 18). A sharp declivity which may be an erosional feature, such as a shallow stream channel, was observed at the northeast corner of the 1993 Public Archaeology excavation (1041N/1034W) (Kroker and Gundry n.d.). Alternatively, this declivity may represent a ground level sloping to the north and the east, which may mean that the Archaic horizon is buried under a greater depth of overburden at the location of the assessment trenches. In an attempt to locate the Archaic horizon, the western end of the east/west trench was excavated to the full extension of the bucket

thin, it probably has been incorporated into the 'Plow Zone'. The Stage I Monitoring Program (Kroker and Gundry 1990:149). Wherever the deposit is relatively bank of the Assiniboine. It has been recorded at North Point Node (Adams *et al.* 1990) and during Kroker *et al.* 1991; Kroker *et al.* 1992). The 1826 sand horizon is intermittent at or near the north sand layer has been recorded at the Fort Gibraltar I site (Preis *et al.* 1986; Kroker *et al.* 1990; are all three flood episodes represented. The greatest recorded flood (1826) occurred prior to the establishment of the Experimental Farm and is often represented by a thick stratum of sand. This 1882, 1861, and 1852. The thin strata between the horizons are not continuous and, in no location, 'Plow Zone'. Three major floods are recorded between the times represented by the two strata: Thin layers of silt, with slight organic colouration, were observed between the 'Clay Fill' and

collected and was identified as ash (DILg-33:93B/161). 'Plow Zone' but were truncated at the top of the stratum. A portion of the more complete post was trench (Figure 4), with a twelve foot separation between them. The posts extended through the Zone' relating to the agricultural activities of the Hudson's Bay Company Experimental Farm charcoal, faunal remains, and 19th century artifacts. This horizon is deemed to represent the 'Plow A deeper horizon, 10 to 20 cm thick, consisted of dark brown silty clay with an admixture of

Stratum' (Kroker 1989:Figure 15, Figure 17). during the North Assiniboine Node Assessment, where it was termed the 'Disturbed Historic



arm of the backhoe (330 cm). No relict soils or cultural horizons were observed. It would seem that the Archaic horizon is not present at this location or, if so, is more deeply buried.

Extensive recent disturbance was observed at the north end of the north/south trench, the centre of the north/south trench, and the centre of the east/west trench. These disturbed zones were capped by a portion of the railroad deposits (Figure 4; Figure 5). The extent of the disturbance, within the assessment trenches, is due to the assessment trench crossing the original disturbance at an oblique angle (Figure 6). The recent disturbance at the centre of the north/south trench was due to the placement of a currently abandoned water line. This iron pipe was encountered at a depth of 285 cm dba at 14.0 north.

Investigation of earlier maps of the East Yard indicate that a water hydrant was located to the south of the centre of the assessment trenches (Figure 6). This hydrant would have been linked to the internal water system and most likely to the hydrant located between the Stables and the Johnston Terminal. In addition, two outflow pipes are marked on early maps - a 6" pipe from the Johnston Terminal to the Assiniboine River, lying to the west of the Low Line Bridge track, and a 6" pipe from former buildings along the west bank of the Red River, extending into the Red River. Neither sub-surface pipe would be located within the area of the assessment trenches. It is probable that the recent disturbance was a result of the trenching for the placement of the fire hydrants, which are marked on a 1962 map but not on a 1947 map. However, the 1947 map is a generalized site map providing locational context for the construction of the Steam Plant. The absence of the hydrants on this map does not mean that they could not have been in place at that time.

### 3.5 Discussion

A sub-surface feature is proposed for the southern portion of The Forks Heritage Plaza. Several archaeological horizons are known to occur outside the periphery of this circular area. Within the assessment trenches, three cultural horizons were observed: the railroad strata, the 'Clay Fill' stratum, and the Hudson's Bay Company 'Plow Zone'. Artifacts within these three layers are not representative of *in situ* activities, but rather secondary or even tertiary deposition.

The re-deposition aspect is most notable in the lower two strata, wherein ground disturbance activities - ploughing and grading - result in artifacts being moved from one location to another, often more than once. This relocation of artifacts eliminates their connection with the original activities. Thus, the artifacts become less significant in an archaeological sense, as the direct link between the artifacts and the activities of the people who used them has been broken. Interpretation of cultural behaviour based upon this relocated material becomes more tenuous.

The presence of pre-1988 disturbance was noted when the assessment trenches encountered locations of recent fill below the cinder and gravel layers (Figure 4, Figure 5). Using maps, dating between 1947 and 1988, the probable location of sub-surface water pipelines has been plotted (Figure 6). In addition, the hydrant from the 1962 map is plotted and linked to the main waterline by a dashed line indicating the most probable route. Using the same scale and grid orientation, the locations of the impact assessment trenches have been superimposed upon the map.

Figure 6: Location of Assessment Trenches and Prior Disturbances

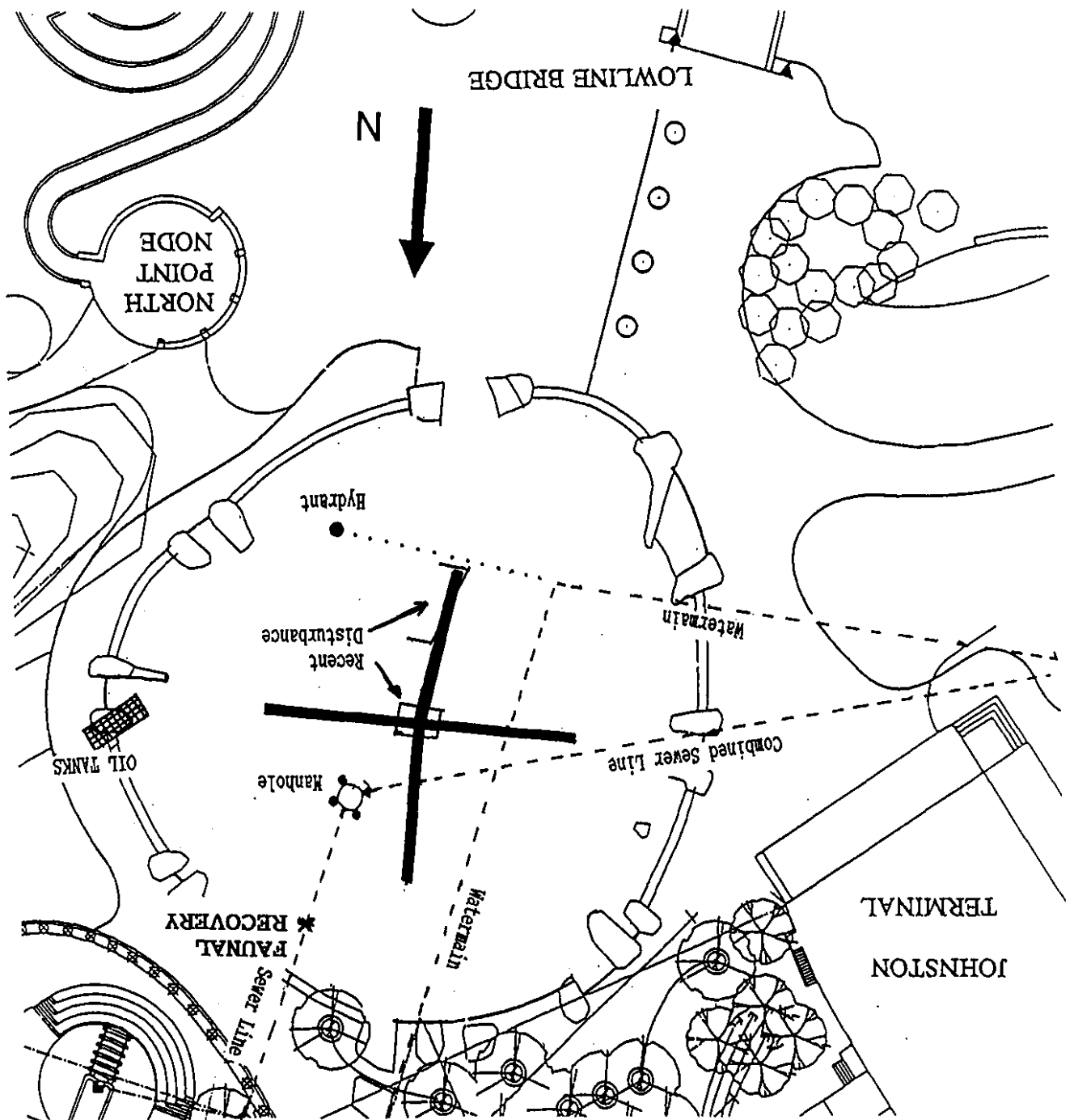

Finally, the locations of the 'Recent Disturbance' strata are marked on the trenches. There is minimal congruence between the waterline locations as derived from early maps and the observed areas of disruption during the assessment. This leads to the hypothesis that the early maps are 'planning maps' or 'long-after-the-fact best-guess maps' rather than 'as-built maps'. It could also mean surveying errors, either then or now. If the location of the waterline route is displaced eastward on the map by approximately eight meters, the route coincides fairly closely with the locations of 'Recent Disturbance' sediments. There may have been a bend or angle in the waterline, to enable linkage with the hydrant.

In addition to the hydrant, the 1962 map shows the presence of oil tanks, one quarter of the distance between the hydrant and the southeastern corner of the B&B Annex. When placed on the composite map (Figure 6), they seem to be located at the eastern edge of the orrery. Sub-surface impact occurred at this location in 1988 when the tanks, and their concrete supporting structures, were removed by CN. It is worth noting that two Pre-Contact cultural strata were recorded within the severely diesel fuel-stained soil - at 254 cm and 286 cm dbs (Kroker 1988). Considerable fish bone and scale were in these strata and they may be temporally similar to the two Archaic strata identified in the FRC Archaeological Preserve.

Given the results of the impact assessment, it can be stated that the major Archaic cultural horizon does not extend into the potential zone of sub-surface impact. Inasmuch as the depth of impact is to be two meters or less below surface, the assessment trenches investigated the sediments for a considerable distance below probable impact. This was done for two reasons: to determine if the Archaic horizon was present and to ensure that the assessment investigation exceeded the probable depths of potential impact by a considerable margin.

The absence of cultural resources in strata below the HBC Experimental Farm Plow Zone does not indicate that the area was not utilized during the Pre-Contact period. Small localized activity areas or campsites could occur within the impact zone and were sited such that they were not encountered by the assessment trenches. However, the absence of cultural resources in the relict soil horizons does indicate that extensive campsites and occupation areas, such as the Archaic horizon or the ceramic horizons at North Point Node, do not extend throughout the impact zone.

### ***3.6 Recommendations***

As noted above, extensive Pre-Contact occupations do not occur within the impact zone. However, as the absence of cultural resources within the assessment trenches only precludes extensive horizons, the presence of small campsites or activity areas associated with any or all of the archaeological occupations known on the periphery of the area must still be considered as a distinct possibility. Accordingly, Quaternary Consultants Limited **recommends that:**

1. any excavation below the railroad strata (gravels, sands, and cinders) be monitored by archaeologists;
2. the archaeological monitoring team be empowered to relocate or stop construction activities if archaeological resources are encountered; and
3. adequate funding be available for mitigative action, if required.

## 4.0 Monitoring of the Cobblestone Court

Sub-surface impact in the cobblestone court portion of the plaza consisted of relocation of an existing manhole and drilling holes for the footings of five lamp standards. Considerable impact has already taken place within this area during the Stage I services installation (Kroker and Goundry 1990) and the extension of services to the B&B Building for the Childrens Museum development (Quaternary n.d.).

Archaeological monitoring of the auger drilling of the hard court plaza manhole was anticipated. The initial location of the manhole was adjacent to or within an undisturbed area. The Senior Archaeologist was to be advised by the contractor prior to the drilling of this bore hole. As plans were modified, the siting of the manhole coincided with a previously disturbed area (Figure 7). The contractor contacted the Senior Archaeologist, after the operation had taken place, that the entire bore hole was within recent infill material (sands and gravels).

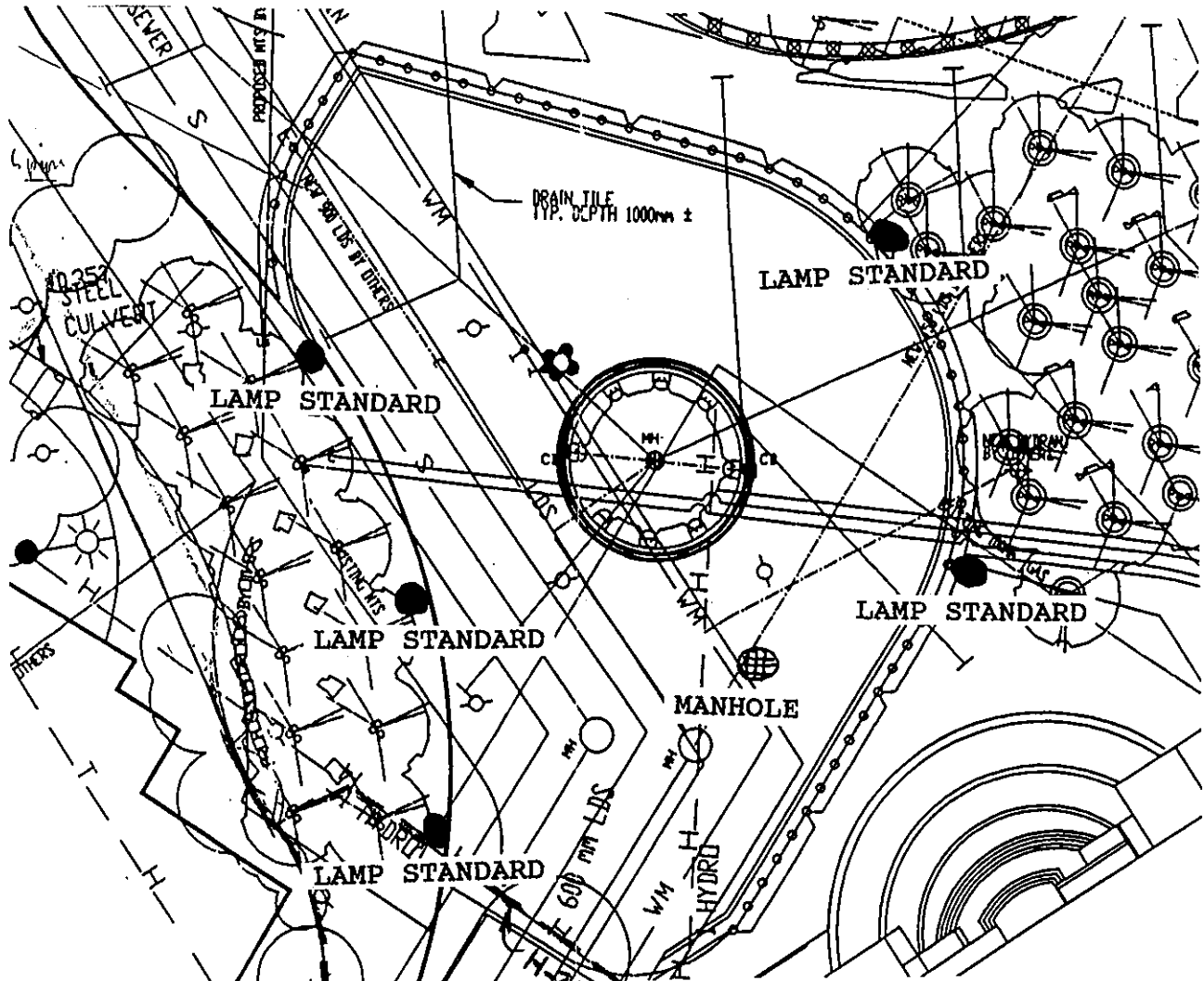

Figure 7: Location of Plaza Manhole and Lamp Standards

The placement of the five lamp standard locations (Figure 7) required auger boring to a depth of 8 feet (2.4 m). The bore diameter was 10" (25.5 cm). The stratigraphy was similar in that the upper horizons within all holes replicated the gravel and cinder strata observed in the assessment trenches. At an average depth of 1.2 m, original riverine sediments were encountered. The three auger holes on the north side had no discernible organic or relict soil horizons within the riverine silts and clays. The southeast auger hole encountered diesel staining of the upper clays and a minor trace of an indistinct buried soil horizon at an approximate depth of 1.5 m. The southwest auger hole provided no indications of relict soil horizons.

## 5.0 Monitoring of the Orrery Land Drainage Line

In conjunction with the installation of land drainage (storm sewer) lines to the B&B Building, as part of the site services for the Childrens Museum, the landscape architect decided that it was economically feasible to establish an extension to the proposed orrery. This new line replaces an abandoned combined sewer line that had originally extended from the B&B Building, south of the Johnston Terminal, to the south side of the Stables (Figure 6). The unused line had been encountered during the North Assiniboine Node Assessment (Kroeker 1989:163, Figure 14, Figure 18). During development of the Assiniboine Riverfront Quay, this line was eliminated within the development zone. The eastward extension terminated in a manhole at the apex of a triangle between the B&B Building and the Johnston Terminal, before running parallel to the B&B Building. The new land drainage line was a direct replacement for the existing line and the construction consisted of removing the old line between the B&B Building and the manhole and replacing it with new materials. Archaeological monitoring took place on August 6 and 9, 1993. In most cases, the excavation took place within the existing area of disturbance, although the excavations were slightly wider than the original to ensure adequate backfilling for safety considerations.

On August 9, a small deposit of faunal remains was encountered at a depth of 190 cm at a distance of 19 meters south of the B&B junction (Figure 6). No lithic or ceramic artifacts were associated with the faunal material. The recoveries (Appendix B) consisted of 144 elements (DILG-33:93E/42-55). These were identified as large Artiodactyla, probably *Bison bison*. The bone appeared to be pathological, in that old, healed breaks were evident. Indications of severe arthritis were present. No cutmarks or other distinct indications of butchering were observed. However, the incompleteness of the skeletal remains and the presence of elements from different portions of the body suggest that this occurrence is not the result of natural deposition.

The specimens were recovered from a localized concentration, lying on and within a relict soil horizon (Figure 8). Prior construction had resulted in impact on the northern edge of the deposit (Figure 8). A series of relict soil zones were observed at this location with one layer above and another layer below the bone deposit. All three relict soils occur below the Experimental Farm Plow Zone. The stratigraphic location indicates that the bone deposit would have occurred considerably prior to 1836 and represents a late Pre-Contact event. The lack of tools, lithic detritus, or ceramic sherds suggests that this was possibly a midden deposit. The living area would have probably been nearby but not immediately adjacent to this refuse deposit.

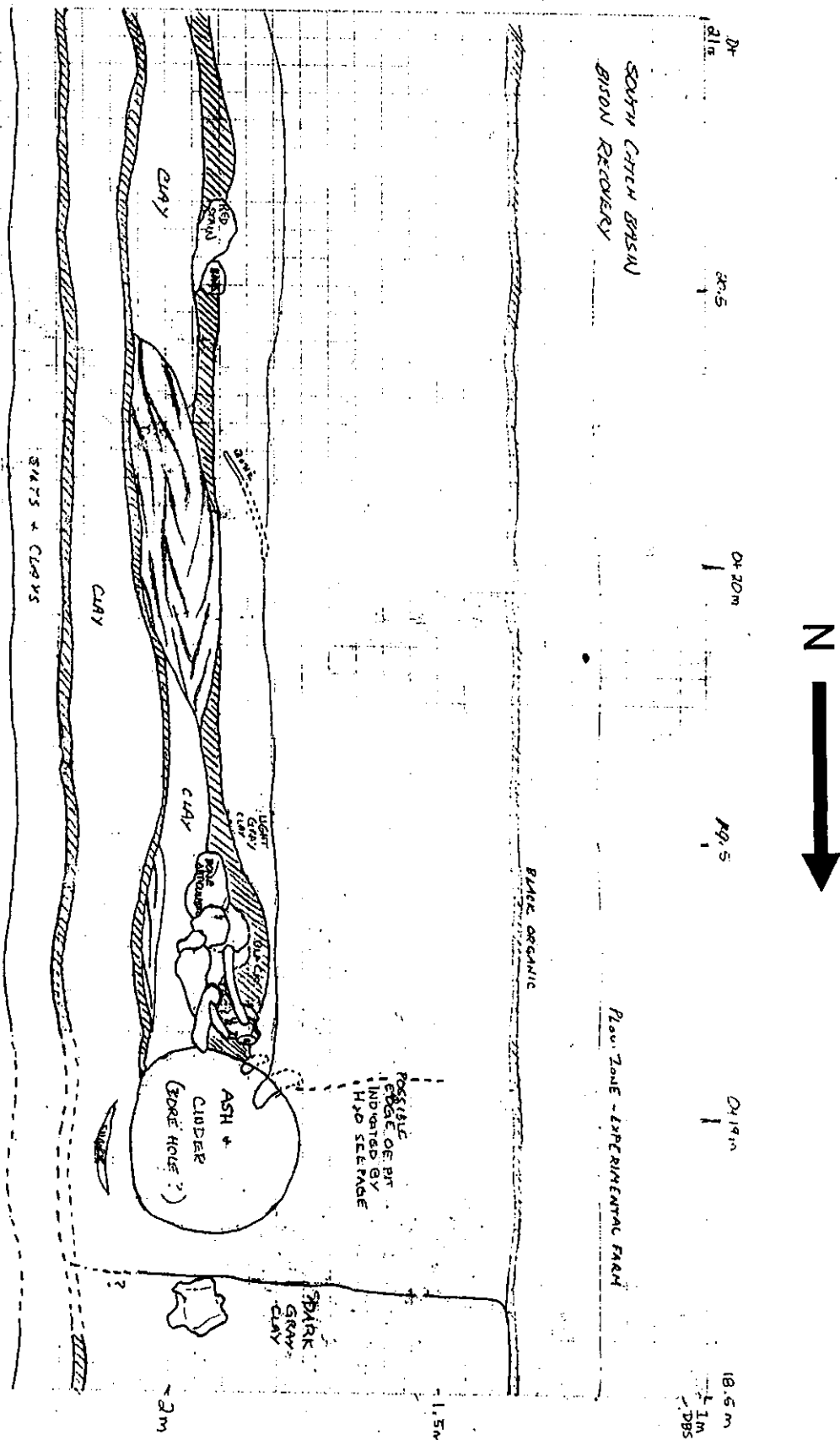

Figure 8: Field Sketch of Bone Bed

## 6.0 Bibliography

Adams, G., K. Lunn, M. A. Tisdale and P. J. Priess

1990 Archaeological Investigations at the Forks National Historic Site, Winnipeg: Mitigation of the North Point Development. Environment Canada, Parks Service, *Research Bulletin* No. 283.

Ashdown Hardware Company

1909 *Ashdown Catalogue*. Ashdown Hardware Co., Winnipeg.

Chopping, George C.

1978 *Bottles of the Canadian Prairies*. Self-published: George C. Chopping, Spy Hill, Saskatchewan.

Forks Renewal Corporation, The

1988 *The Forks Archaeological Impact Assessment and Development Plan (The Forks Archaeological Plan)*. The Forks Renewal Corporation, Winnipeg.

Guinn, Rodger

1980 The Red-Assiniboine Junction: A Land Use and Structural History. *Manuscript Report Series* No. 355, Parks Canada. Ottawa.

HBT AGRA Limited

1993 Geotechnical Investigation Forks Market Road, Earth Sculpture and Orrery. Report on File with Hilderman Witty Crosby Hanna & Associates and The Forks Renewal Corporation.

Jones, Olive R. and Catherine Sullivan, *et al.*

1985 *The Parks Canada Glass Glossary*. Environment Canada, Parks Canada, National Historic Parks and Sites Branch.

Kovel, Ralph M. & Terry H. Kovel

1986 *Kovels' New Dictionary of Marks*. Crown Publishers, New York.

Kroker, Sid

1988 Field Notes for the North Assiniboine Node Archaeological (NANA) Impact Assessment.

1989 *North Assiniboine Node Archaeological Impact Assessment*. The Forks Renewal Corporation, Winnipeg.

Kroker, Sid and Pamela Goundry

1990 *Archaeological Monitoring of the Stage I Construction Program*. The Forks Renewal Corporation, Winnipeg.

1993a *Archaeological Monitoring and Mitigation of the Assiniboine Riverfront Quay*. The Forks Renewal Corporation, Winnipeg.

1993b *A 3000 Year Old Native Campsite and Trade Centre At The Forks*. Compiled by Sid Kroker and Pam Goundry. The Forks Public Archaeological Association, Inc., Winnipeg.

n.d. The 1993 Public Archaeology Project at The Forks. Compiled by Sid Kroker and Pam Goundry. The Forks Public Archaeological Association, Inc., Winnipeg. [In Preparation]

Kroker, Sid, Barry B. Greco, Arda Melikian and David K. Riddle

1990 *The Forks (1989) Pilot Public Archaeology Project: Research Report Excavations at 21K (Fort Gibraltar I)*. Canadian Parks Services, Historic Resources Branch and The Forks Renewal Corporation, Winnipeg.

Kroker, Sid, Barry B. Greco and A. Kate Peach

1992 *1991 Investigations at Fort Gibraltar I: The Forks Public Archaeology Project*. The Forks Public Archaeology Association Inc., Winnipeg.

Kroker, Sid, Barry B. Greco and Sharon Thomson

1991 *1990 Investigations at Fort Gibraltar I : The Forks Public Archaeology Project*. Canadian Parks Services, Historic Resources Branch and The Forks Renewal Corporation, Winnipeg.

Manitoba Museum of Man and Nature

1986 *Guides and Manuals for Processing Archaeological Materials*. E.L. Syms (Ed.). Winnipeg, Manitoba.



Priess, Peter J., P. W. Nieuwhof, & S. B. Ebell

1986 Archaeological Investigations of the Junction of the Red and Assiniboine River, 1984. Parks Canada, *Research Bulletin* No. 241.

Quaternary Consultants Ltd.

1993 Archaeological Mitigation of the Johnston Terminal Refurbishment Project. Report on File with Marwest Management Canada Ltd, Historic Resources Branch and The Forks Renewal Corporation, Winnipeg.

n.d. Archaeological Monitoring of Site Services Installations for the Childrens Museum at The Forks. [In Preparation]

Sussman, Lynne

1985 *The Wheat Pattern; An Illustrated Survey*. Environment Canada, Parks Canada, National History Parks and Sites Branch, Architecture and History, Studies in Archaeology.

**APPENDIX A**

**HERITAGE PERMITS**



**Heritage Permit No.** A23-93

FORM 11

PURSUANT to Section/~~Subsection~~ 53 of *The Heritage Resources Act*:

Name: Quaternary Consultants Ltd.  
Address: 130 Fort Street  
Winnipeg MB R3C 1C7  
  
ATTENTION Mr Sid Kroker

(hereinafter referred to as "the Permittee"),

is hereby granted permission to:

carry out the monitoring of soil test augering at nine locations between the Johnston Terminal, the B and B Building, and the Low-Line bridge at the Forks (D1Lg-33) in Downtown Winnipeg;

during the period:

June 14, 1993

This permit is issued subject to the following conditions:

- (1) That the information provided in the application for this permit dated the 9th day of June 1993, is true in substance and in fact;
- (2) That the Permittee shall comply with all the provisions of *The Heritage Resources Act* and any regulations or orders thereunder; PLEASE NOTE ATTACHMENT RE CUSTODY AND OWNERSHIP OF HERITAGE OBJECTS
- (3) That the Permittee shall provide to the Minister a written report or reports with respect to the Permittee's activities pursuant to this permit, the form and content of which shall be satisfactory to the Minister and which shall be provided on the following dates:  
July 30, 1993
- (4) That this permit is not transferable;
- (5) This permit may be revoked by the Minister where, in the opinion of the Minister, there has been a breach of any of the terms or conditions herein or of any provision of *The Heritage Resources Act* or any regulations thereunder;

(6) Special Conditions:

- a. All surface collections, excavations, etc. are to be carried out using the provenience system established for use at The Forks and this project will be designated 93A;
- b. All heritage objects (artifacts) recovered from The Forks are to be catalogued according to the CHIN system and the relevant Borden designation will be D1Lg-33/93A;
- c. All heritage objects from The Forks are to be deposited with the Manitoba Museum of Man and Nature by March 31, 1994, for permanent curation and storage, unless appropriate loan requirements are arranged with the Curator of Archaeology prior to that date;
- d. A complete set of archaeological field records, catalogue sheets, laboratory analysis records, photographs, reports, etc. are to be deposited with the Manitoba Museum of Man and Nature upon completion of the archaeological research, or sooner if required; and any subsequent revisions or additions to these records are to be filed as soon as possible thereafter;
- e. All computer systems and programs employed in archaeological research should be compatible with the computer system established for The Forks;
- f. Appropriate arrangements and funds should be made available for the conservation of perishable heritage objects collected from The Forks;
- g. In the event that any human remains are encountered during the excavations, all activity in that particular locus will cease immediately, and the Historic Resources Branch notified immediately so that appropriate action can be determined and taken;
- h. The Permittee will be on-site supervising all aspects of the field work, including the removal of the railroad overburden during site preparation, at least 75% of the time, but when the Permittee must be absent, a qualified designate acceptable to Historic Resources Branch (copy of vita to be filed prior to commencement of field work) shall be present;
- i. The Permittee shall be responsible for the conduct of the laboratory analysis of recovered heritage objects and information to be included in the permit report;
- j. The report identified in #3 above shall conform at a minimum to "The Contents and Format of a Heritage Resource Impact Assessment" (copy attached)
- k. Neither the Government of Manitoba nor the party issuing this permit be liable for any damages resulting from any activities carried out pursuant to this permit, and the Permittee specifically agrees, in consideration for receiving this permit, to indemnify and hold harmless the Minister and the Government of Manitoba, the Minister and any employees and officials of the Government, against any and all action, liens, demands, loss, liability, cost, damage and expense including, without limitation, reasonable legal fees, which the Government, Minister or any employee or official of the Government may suffer or incur by reason of any of the activities pursuant to or related to this permit.

8280h

Dated at the City of Winnipeg, in Manitoba, this 9th day of June 1993.

  
Minister of Culture, Heritage and Citizenship



**Heritage Permit No.**

A28-93

FORM 11

**PURSUANT** to Section/~~Subsection~~ 53 of *The Heritage Resources Act*:

Name: Quaternary Consultants Ltd.  
Address: 130 Fort St  
Winnipeg MB R3C 1C7  
  
ATTENTION Mr Sid Kroker

(hereinafter referred to as "the Permittee"),

is hereby granted permission to:

carry out an impact assessment of the proposed Plaza Area, between the Johnston Terminal, the B and B Building, and the Low-Line bridge at The Forks (D1Lg-33) in Downtown Winnipeg to determine the presence or absence of heritage resources and their nature and extent if present;

during the period:

July 6 to 23, 1993

This permit is issued subject to the following conditions:

- (1) That the information provided in the application for this permit dated the 18th day of June 19 93, is true in substance and in fact;
- (2) That the Permittee shall comply with all the provisions of *The Heritage Resources Act* and any regulations or orders thereunder; PLEASE NOTE ATTACHMENT RE CUSTODY AND OWNERSHIP OF HERITAGE OBJECTS
- (3) That the Permittee shall provide to the Minister a written report or reports with respect to the Permittee's activities pursuant to this permit, the form and content of which shall be satisfactory to the Minister and which shall be provided on the following dates:  
December 31, 1993
- (4) That this permit is not transferable;
- (5) This permit may be revoked by the Minister where, in the opinion of the Minister, there has been a breach of any of the terms or conditions herein or of any provision of *The Heritage Resources Act* or any regulations thereunder;

(6) Special Conditions:

- a. All surface collections, excavations, etc. are to be carried out using the provenience system established for use at The Forks and this project will be designated 93B;
- b. All heritage objects (artifacts) recovered from The Forks are to be catalogued according to the CHIN system and the relevant Borden designation will be D1Lg-33/93B;
- c. All heritage objects from The Forks are to be deposited with the Manitoba Museum of Man and Nature by March 31, 1994, for permanent curation and storage, unless appropriate loan requirements are arranged with the Curator of Archaeology prior to that date;
- d. A complete set of archaeological field records, catalogue sheets, laboratory analysis records, photographs, reports, etc. are to be deposited with the Manitoba Museum of Man and Nature upon completion of the archaeological research, or sooner if required; and any subsequent revisions or additions to these records are to be filed as soon as possible thereafter;
- e. All computer systems and programs employed in archaeological research should be compatible with the computer system established for The Forks;
- f. Appropriate arrangements and funds should be made available for the conservation of perishable heritage objects collected from The Forks;
- g. In the event that any human remains are encountered during the excavations, all activity in that particular locus will cease immediately, and the Historic Resources Branch notified immediately so that appropriate action can be determined and taken;
- h. The Permittee will be on-site supervising all aspects of the field work, including the removal of the railroad overburden during site preparation, at least 75% of the time, but when the Permittee must be absent, a qualified designate acceptable to Historic Resources Branch (copy of vita to be filed prior to commencement of field work) shall be present;
- i. The Permittee shall be responsible for the conduct of the laboratory analysis of recovered heritage objects and information to be included in the permit report;
- j. The report identified in #3 above shall conform at a minimum to "The Contents and Format of a Heritage Resource Impact Assessment" (copy attached)
- k. Neither the Government of Manitoba nor the party issuing this permit be liable for any damages resulting from any activities carried out pursuant to this permit, and the Permittee specifically agrees, in consideration for receiving this permit, to indemnify and hold harmless the Minister and the Government of Manitoba, the Minister and any employees and officials of the Government, against any and all action, liens, demands, loss, liability, cost, damage and expense including, without limitation, reasonable legal fees, which the Government, Minister or any employee or official of the Government may suffer or incur by reason of any of the activities pursuant to or related to this permit.

8280h

Dated at the City of Winnipeg, in Manitoba, this 23rd day of June 1993

  
\_\_\_\_\_  
for Minister of Culture, Heritage and Citizenship



**Heritage Permit No.** A33-93

FORM 11

PURSUANT to Section/Subsection 53 of *The Heritage Resources Act*:

Name: Quaternary Consultants Ltd  
Address: 130 Fort Street  
Winnipeg MB R3C 1C7

ATTENTION Mr Sid Kroker

(hereinafter referred to as "the Permittee"),

is hereby granted permission to:

carry out the archaeological monitoring of components of The Forks Plaza (North Traffic Loop) which are greater than 0.9 m in depth, specifically one manhole adjacent to the Johnston Terminal at the Forks (D1Lg-33) in Downtown Winnipeg in order to record stratigraphic sequences and recover archaeological data from any pre-1888 horizons which may be encountered;

during the period:

August 4 to September 15, 1993

This permit is issued subject to the following conditions:

- (1) That the information provided in the application for this permit dated the 26th day of July 1993, is true in substance and in fact;
- (2) That the Permittee shall comply with all the provisions of *The Heritage Resources Act* and any regulations or orders thereunder;
- (3) That the Permittee shall provide to the Minister a written report or reports with respect to the Permittee's activities pursuant to this permit, the form and content of which shall be satisfactory to the Minister and which shall be provided on the following dates:  
March 31, 1994
- (4) That this permit is not transferable;
- (5) This permit may be revoked by the Minister where, in the opinion of the Minister, there has been a breach of any of the terms or conditions herein or of any provision of *The Heritage Resources Act* or any regulations thereunder;

(6) Special Conditions:

- a. All surface collections, excavations, etc. are to be carried out using the provenience system established for use at The Forks and this project will be designated 93D;
- b. All heritage objects (artifacts) recovered from The Forks are to be catalogued according to the CHIN system and the relevant Borden designation will be D1Lg-33/93D;
- c. All heritage objects from The Forks are to be deposited with the Manitoba Museum of Man and Nature by March 31, 1994, for permanent curation and storage, unless appropriate loan requirements are arranged with the Curator of Archaeology prior to that date;
- d. A complete set of archaeological field records, catalogue sheets, laboratory analysis records, photographs, reports, etc. are to be deposited with the Manitoba Museum of Man and Nature upon completion of the archaeological research, or sooner if required; and any subsequent revisions or additions to these records are to be filed as soon as possible thereafter;
- e. All computer systems and programs employed in archaeological research should be compatible with the computer system established for The Forks;
- f. Appropriate arrangements and funds should be made available for the conservation of perishable heritage objects collected from The Forks;
- g. In the event that any human remains are encountered during the excavations, all activity in that particular locus will cease immediately, and the Historic Resources Branch notified immediately so that appropriate action can be determined and taken;
- h. The Permittee will be on-site supervising all aspects of the field work, including the removal of the railroad overburden during site preparation, at least 75% of the time, but when the Permittee must be absent, a qualified designate acceptable to Historic Resources Branch (copy of vita to be filed prior to commencement of field work) shall be present;
- i. The Permittee shall be responsible for the conduct of the laboratory analysis of recovered heritage objects and information to be included in the permit report;
- j. The report identified in #3 above shall conform at a minimum to "The Contents and Format of a Heritage Resource Impact Assessment" (copy attached)
- k. Neither the Government of Manitoba nor the party issuing this permit be liable for any damages resulting from any activities carried out pursuant to this permit, and the Permittee specifically agrees, in consideration for receiving this permit, to indemnify and hold harmless the Minister and the Government of Manitoba, the Minister and any employees and officials of the Government, against any and all action, liens, demands, loss, liability, cost, damage and expense including, without limitation, reasonable legal fees, which the Government, Minister or any employee or official of the Government may suffer or incur by reason of any of the activities pursuant to or related to this permit.

8280h

Dated at the City of Winnipeg, in Manitoba, this 27th day of July 1993.

  
Minister of Culture, Heritage and Citizenship





**Heritage Permit No.** A34-93

FORM 11

PURSUANT to Section/Subsection 53 of *The Heritage Resources Act*:

Name: Quaternary Consultants Ltd  
Address: 130 Fort St  
Winnipeg MB R3C 1C7

ATTENTION Mr Sid Kroker

(hereinafter referred to as "the Permittee"),

is hereby granted permission to:

carry out an archaeological impact assessment and monitoring of the proposed land drainage, water main, sanitary sewer and hydro connections as identified in the plan attached to the permit application for the Manitoba Children's Museum in the B and B Building at The Forks (DLG-33) in Downtown Winnipeg to determine the presence or absence of heritage resources and their nature and extent if present;

during the period:

August 3 to September 30, 1993

This permit is issued subject to the following conditions:

- (1) That the information provided in the application for this permit dated the 27th day of July 1993, is true in substance and in fact;
- (2) That the Permittee shall comply with all the provisions of *The Heritage Resources Act* and any regulations or orders thereunder; PLEASE NOTE ATTACHMENT RE CUSTODY AND OWNERSHIP OF HERITAGE OBJECTS
- (3) That the Permittee shall provide to the Minister a written report or reports with respect to the Permittee's activities pursuant to this permit, the form and content of which shall be satisfactory to the Minister and which shall be provided on the following dates:  
March 31, 1994
- (4) That this permit is not transferable;
- (5) This permit may be revoked by the Minister where, in the opinion of the Minister, there has been a breach of any of the terms or conditions herein or of any provision of *The Heritage Resources Act* or any regulations thereunder;

(6) Special Conditions:

- a. All surface collections, excavations, etc. are to be carried out using the provenience system established for use at The Forks and this project will be designated 93E;
- b. All heritage objects (artifacts) recovered from The Forks are to be catalogued according to the CHIN system and the relevant Borden designation will be D1Lg-33/93E;
- c. All heritage objects from The Forks are to be deposited with the Manitoba Museum of Man and Nature by March 31, 1994, for permanent curation and storage, unless appropriate loan requirements are arranged with the Curator of Archaeology prior to that date;
- d. A complete set of archaeological field records, catalogue sheets, laboratory analysis records, photographs, reports, etc. are to be deposited with the Manitoba Museum of Man and Nature upon completion of the archaeological research, or sooner if required; and any subsequent revisions or additions to these records are to be filed as soon as possible thereafter;
- e. All computer systems and programs employed in archaeological research should be compatible with the computer system established for The Forks;
- f. Appropriate arrangements and funds should be made available for the conservation of perishable heritage objects collected from The Forks;
- g. In the event that any human remains are encountered during the excavations, all activity in that particular locus will cease immediately, and the Historic Resources Branch notified immediately so that appropriate action can be determined and taken;
- h. The Permittee will be on-site supervising all aspects of the field work, including the removal of the railroad overburden during site preparation, at least 75% of the time, but when the Permittee must be absent, a qualified designate acceptable to Historic Resources Branch (copy of vita to be filed prior to commencement of field work) shall be present;
- i. The Permittee shall be responsible for the conduct of the laboratory analysis of recovered heritage objects and information to be included in the permit report;
- j. The report identified in #3 above shall conform at a minimum to "The Contents and Format of a Heritage Resource Impact Assessment" (copy attached)
- k. Neither the Government of Manitoba nor the party issuing this permit be liable for any damages resulting from any activities carried out pursuant to this permit, and the Permittee specifically agrees, in consideration for receiving this permit, to indemnify and hold harmless the Minister and the Government of Manitoba, the Minister and any employees and officials of the Government, against any and all action, liens, demands, loss, liability, cost, damage and expense including, without limitation, reasonable legal fees, which the Government, Minister or any employee or official of the Government may suffer or incur by reason of any of the activities pursuant to or related to this permit.

8280h

Dated at the City of Winnipeg, in Manitoba, this 27th day of July 1993.

  
Minister of Culture, Heritage and Citizenship

**APPENDIX B**

**CATALOGUE OF ARTIFACTS**

## SPECIMEN CATALOGUE RECORD

Site: DLG-33:93B THE FORKSArea: RED RIVERClient: THE FORKS RENEWAL CORP.

Acc. No.: \_\_\_\_\_

Cat. #	Qty	Object Name / Object Type	Material / Cultural Phase	Location / Unit	Coll. Date
1	1	SPIKE	IRON INDUSTRIAL	PLAZA NORTH TRENCH	19930707
2	1	NAIL SQUARE	IRON INDUSTRIAL	PLAZA NORTH TRENCH	19930707
3	1	SHERD BOTTLE	GLASS INDUSTRIAL	PLAZA NORTH TRENCH	19930707
4	1	PIPE	BAKELITE INDUSTRIAL	PLAZA NORTH TRENCH	19930707
5	1	FORK	STEEL INDUSTRIAL	PLAZA NORTH TRENCH	19930707
6	1	NAIL ROUND	IRON INDUSTRIAL	PLAZA NORTH TRENCH	19930707
7	3	SHERD BOWL?	PORCELAIN INDUSTRIAL	PLAZA NORTH TRENCH	19930707
8	1	SHERD CROCK	STONEWARE INDUSTRIAL	PLAZA NORTH TRENCH	19930707
9	1	SCRAP	TIN INDUSTRIAL	PLAZA NORTH TRENCH	19930707
10	1	WINDOWPANE	GLASS INDUSTRIAL	PLAZA NORTH TRENCH	19930707
11	1	VALVE UNIONIDAE	SHELL INDUSTRIAL	PLAZA NORTH TRENCH	19930707
12	1	SHERD PLATE?//SAUCER?	PORCELAIN INDUSTRIAL	PLAZA NORTH TRENCH	19930707
13	1	SHERD PLATE	PORCELAIN INDUSTRIAL	PLAZA NORTH TRENCH	19930707
14	2	SHERD CUP	PORCELAIN INDUSTRIAL	PLAZA NORTH TRENCH	19930707
15	1	SHERD PLATE	PORCELAIN INDUSTRIAL	PLAZA NORTH TRENCH	19930707
16	1	SHERD BOWL?// CUP?	PORCELAIN INDUSTRIAL	PLAZA NORTH TRENCH	19930707
17	1	SHERD BOTTLE	GLASS INDUSTRIAL	PLAZA NORTH TRENCH	19930707
18	1	SHERD BOTTLE	GLASS INDUSTRIAL	PLAZA NORTH TRENCH	19930707
19	1	SHERD BOTTLE	GLASS INDUSTRIAL	PLAZA NORTH TRENCH	19930707
20	1	SHERD BOTTLE	GLASS INDUSTRIAL	PLAZA NORTH TRENCH	19930707
21	2	SHERD JAR	GLASS INDUSTRIAL	PLAZA NORTH TRENCH	19930707
22	1	SHERD BOWL	PORCELAIN INDUSTRIAL	PLAZA NORTH TRENCH	19930707
23	1	SCRAP	TIN INDUSTRIAL	PLAZA NORTH TRENCH	19930707
24	1	SPIKE	IRON INDUSTRIAL	PLAZA NORTH TRENCH	19930707
25	1	SCRAP	IRON INDUSTRIAL	PLAZA NORTH TRENCH	19930707

SPECIMEN CATALOGUE RECORD

Site: DLG-33:93B THE FORKS Area: RED RIVER

Client: THE FORKS RENEWAL CORP.

Acc. No.:

Cat. # Qty Object Name / Object Type Material / Cultural Phase Location / Unit Coll. Date

19930707	1	INNOMINATE	BONE	PLAZA	NORTH TRENCH	19930707
26	1	SUS SCROFA	INDUSTRIAL	PLAZA	NORTH TRENCH	19930707
27	1	LONG BONE	BONE	PLAZA	NORTH TRENCH	19930707
28	1	UNIDENTIFIED	BONE	PLAZA	NORTH TRENCH	19930707
29	1	LONG BONE	BONE	PLAZA	NORTH TRENCH	19930707
30	1	SHERD BOTTLE	GLASS	PLAZA	NORTH TRENCH	19930707
31	1	SHERD BOTTLE	GLASS	PLAZA	NORTH TRENCH	19930707
32	1	SHERD BOTTLE	GLASS	PLAZA	NORTH TRENCH	19930707
33	1	HANDLE	IRON	PLAZA	NORTH TRENCH	19930707
34	8	WINDOWPANE	GLASS	PLAZA	NORTH TRENCH	19930707
35	1	SHERD BOTTLE	GLASS	PLAZA	NORTH TRENCH	19930707
36	2	SHERD BOTTLE	GLASS	PLAZA	NORTH TRENCH	19930707
37	1	WINDOWPANE	GLASS	PLAZA	NORTH TRENCH	19930707
38	1	WINDOWPANE	GLASS	PLAZA	NORTH TRENCH	19930707
39	1	WINDOWPANE	GLASS	PLAZA	NORTH TRENCH	19930707
40	1	GAUGE	GLASS	PLAZA	NORTH TRENCH	19930707
41	1	SHERD BOTTLE	GLASS	PLAZA	NORTH TRENCH	19930707
42	1	LANTERN	GLASS	PLAZA	NORTH TRENCH	19930707
43	1	MAIL	IRON	PLAZA	NORTH TRENCH	19930707
44	2	MAIL	IRON	PLAZA	NORTH TRENCH	19930707
45	1	SCRAP	BAKELITE	PLAZA	NORTH TRENCH	19930707
46	1	SAMPLE FISH	BONE	PLAZA	NORTH TRENCH	19930707
47	1	SHERD BOTTLE	GLASS	PLAZA	NORTH TRENCH	19930707
48	1	SHERD BOTTLE	GLASS	PLAZA	NORTH TRENCH	19930707
49	1	WINDOWPANE	GLASS	PLAZA	NORTH TRENCH	19930707
50	1	SHERD PLATE?/SAUCER?	PORCELAIN	PLAZA	NORTH TRENCH	19930707

SPECIMEN CATALOGUE RECORD

Site: D1LG-33:93B THE FORKS

Area: RED RIVER

Client: THE FORKS RENEWAL CORP.

Acc. No.:

Cat. # Qty Object Name / Object Type Material / Cultural Phase Location / Unit Coll. Date

Cat. #	Qty	Object Name / Object Type	Material / Cultural Phase	Location / Unit	Coll. Date
51	1	SHERD BOWL?	INDUSTRIAL	PLAZA NORTH TRENCH	19930707
52	1	SHERD BOWL?	INDUSTRIAL	PLAZA NORTH TRENCH	19930707
53	1	RIB MAMMALIA	INDUSTRIAL	PLAZA NORTH TRENCH	19930707
54	1	PHALANX ARTIODACTYLA	INDUSTRIAL	PLAZA NORTH TRENCH	19930707
55	1	IRON NAIL	INDUSTRIAL	PLAZA NORTH TRENCH	19930707
56	1	IRON NAIL UNIDENTIFIED	INDUSTRIAL	PLAZA NORTH TRENCH	19930707
57	1	IRON TRAP	INDUSTRIAL	PLAZA NORTH TRENCH	19930707
58	1	MAXILLA; TOOTH DIVIS	INDUSTRIAL	PLAZA NORTH TRENCH	19930707
59	1	SAMPLE BONE	INDUSTRIAL	PLAZA NORTH TRENCH	19930707
60	5	WINDOWPANE GLASS	INDUSTRIAL	PLAZA NORTH TRENCH	19930707
61	5	WINDOWPANE GLASS	INDUSTRIAL	PLAZA NORTH TRENCH	19930707
62	1	SHERD BOTTLE	INDUSTRIAL	PLAZA NORTH TRENCH	19930707
63	1	SHERD BOTTLE	INDUSTRIAL	PLAZA NORTH TRENCH	19930707
64	1	SHERD BOTTLE	INDUSTRIAL	PLAZA NORTH TRENCH	19930707
65	1	SHERD BOTTLE	INDUSTRIAL	PLAZA NORTH TRENCH	19930707
66	1	SHERD BOWL?	INDUSTRIAL	PLAZA NORTH TRENCH	19930707
67	1	SHERD BOWL? CUP?	INDUSTRIAL	PLAZA NORTH TRENCH	19930707
68	6	SHERD BOWL?	INDUSTRIAL	PLAZA NORTH TRENCH	19930707
69	2	IRON NAIL ROUND	INDUSTRIAL	PLAZA NORTH TRENCH	19930707
70	1	IRON ROPE GREAT	INDUSTRIAL	PLAZA NORTH TRENCH	19930707
71	4	UNIDENTIFIED FISH	INDUSTRIAL	PLAZA NORTH TRENCH	19930707
72	1	HORN CORE ARTIODACTYLA	INDUSTRIAL	PLAZA NORTH TRENCH	19930707
73	1	MAXILLA; TOOTH CARNIVORA	INDUSTRIAL	PLAZA NORTH TRENCH	19930707
74	1	INSULATOR GLASS	INDUSTRIAL	PLAZA NORTH TRENCH	19930707
75	1	SHERD BOTTLE	INDUSTRIAL	PLAZA NORTH TRENCH	19930707

## SPECIMEN CATALOGUE RECORD

Site: DLLG-33:93B THE FORKS

Area: RED RIVER

Client: THE FORKS RENEWAL CORP.

Acc. No.:

Cat. #	Qty	Object Name / Object Type	Material / Cultural Phase	Location / Unit	Coll. Date
76	2	SHERD BOTTLE	GLASS INDUSTRIAL	PLAZA NORTH TRENCH	19930707
77	1	SHERD BOTTLE	GLASS INDUSTRIAL	PLAZA NORTH TRENCH	19930707
78	1	LANTERN	GLASS INDUSTRIAL	PLAZA NORTH TRENCH	19930707
79	1	KNOB CUPBOARD	GLASS INDUSTRIAL	PLAZA NORTH TRENCH	19930707
80	1	LIGHTING FIXTURE ELECTRIC	PORCELAIN; COPPER INDUSTRIAL	PLAZA NORTH TRENCH	19930707
81	1	LIGHT BULB	COPPER INDUSTRIAL	PLAZA NORTH TRENCH	19930707
82	1	BUTTON VERTICAL HOLE	PLASTIC INDUSTRIAL	PLAZA NORTH TRENCH	19930707
83	1	SHERD BOWL	PORCELAIN INDUSTRIAL	PLAZA NORTH TRENCH	19930707
84	1	SHERD BOWL?	PORCELAIN INDUSTRIAL	PLAZA NORTH TRENCH	19930707
85	1	BRICK	GLASS INDUSTRIAL	PLAZA NORTH TRENCH	19930707
86	1	NAIL ROUND	IRON INDUSTRIAL	PLAZA NORTH TRENCH	19930707
87	1	VALVE UNIONIDAE	SHELL INDUSTRIAL	PLAZA NORTH TRENCH	19930707
88	1	VALVE UNIONIDAE	SHELL INDUSTRIAL	PLAZA NORTH TRENCH	19930707
89	1	VERTEBRA MAMMALIA	BONE INDUSTRIAL	PLAZA NORTH TRENCH	19930707
90	4	LONG BONE MAMMALIA	BONE INDUSTRIAL	PLAZA NORTH TRENCH	19930707
91	2	SKULL ARTIODACTYLA	BONE INDUSTRIAL	PLAZA NORTH TRENCH	19930707
92	1	SACRUM ARTIODACTYLA	BONE INDUSTRIAL	PLAZA NORTH TRENCH	19930707
93	1	SHERD BOTTLE	GLASS INDUSTRIAL	PLAZA NORTH TRENCH	19930708
94	1	SHERD BOTTLE	GLASS INDUSTRIAL	PLAZA NORTH TRENCH	19930708
95	1	SHERD BOTTLE	GLASS INDUSTRIAL	PLAZA NORTH TRENCH	19930708
96	1	SHERD BOTTLE	GLASS INDUSTRIAL	PLAZA NORTH TRENCH	19930708
97	2	WINDOWPANE	GLASS INDUSTRIAL	PLAZA NORTH TRENCH	19930708
98	1	SHERD BOWL?	GLASS INDUSTRIAL	PLAZA NORTH TRENCH	19930708
99	1	SCRAP	IRON INDUSTRIAL	PLAZA NORTH TRENCH	19930708
100	1	NAIL SQUARE	IRON INDUSTRIAL	PLAZA NORTH TRENCH	19930708

SPECIMEN CATALOGUE RECORD

Site: DLG-33:93B THE FORKS Area: RED RIVER

Client: THE FORKS RENOVATION CORP.

Acc. No.:

Cat. # Qty Object Name / Object Type Material / Cultural Phase Location / Unit Coll. Date

101	1	CARPUS	BONE	INDUSTRIAL	PLAZA TRENCH	19930708
102	1	RIB	BONE	INDUSTRIAL	PLAZA TRENCH	19930708
103	1	SCAPULA	BONE	INDUSTRIAL	PLAZA TRENCH	19930708
104	2	STRAP	IRON	INDUSTRIAL	PLAZA TRENCH	19930708
105	1	SHERD	PORCELAIN	INDUSTRIAL	PLAZA TRENCH	19930708
106	1	SHERD	PORCELAIN	INDUSTRIAL	PLAZA TRENCH	19930708
107	1	SHERD	PORCELAIN	INDUSTRIAL	PLAZA TRENCH	19930708
108	1	SHERD	PORCELAIN	INDUSTRIAL	PLAZA TRENCH	19930708
109	1	SHERD	GLASS	INDUSTRIAL	PLAZA TRENCH	19930708
110	1	SHERD	GLASS	INDUSTRIAL	PLAZA TRENCH	19930708
111	1	VERTEBRA	BONE	INDUSTRIAL	PLAZA TRENCH	19930708
112	1	HUMERUS	BONE	INDUSTRIAL	PLAZA TRENCH	19930708
113	1	HORN CORE	BONE	INDUSTRIAL	PLAZA TRENCH	19930708
114	1	SKULL	BONE	INDUSTRIAL	PLAZA TRENCH	19930708
115	1	RIB	BONE	INDUSTRIAL	PLAZA TRENCH	19930708
116	3	UNIDENTIFIED	BONE	INDUSTRIAL	PLAZA TRENCH	19930708
117	1	SCAPULA	BONE	INDUSTRIAL	PLAZA TRENCH	19930708
118	1	MAIL	IRON	INDUSTRIAL	PLAZA TRENCH	19930708
119	1	SHERD	GLASS	INDUSTRIAL	PLAZA TRENCH	19930708
120	1	PIPE	KAOLIN	INDUSTRIAL	PLAZA TRENCH	19930708
121	1	SHERD	GLASS	INDUSTRIAL	PLAZA TRENCH	19930708
122	3	SHERD	GLASS	INDUSTRIAL	PLAZA TRENCH	19930708
123	1	SHERD	GLASS	INDUSTRIAL	PLAZA TRENCH	19930708
124	1	SHERD	GLASS	INDUSTRIAL	PLAZA TRENCH	19930708
125	1	RIB	BONE	INDUSTRIAL	PLAZA TRENCH	19930708



SPECIMEN CATALOGUE RECORD

Site: DLG-33:93B THE FORKS

Area: RED RIVER

Client: THE FORKS RENEWAL CORP.

Acc. No.:

Cat. # Qty Object Name / Object Type Material / Cultural Phase Location / Unit Coll. Date

Cat. #	Qty	Object Name / Object Type	Material / Cultural Phase	Location / Unit	Coll. Date
126	1	UNIDENTIFIED BONE	INDUSTRIAL	PLAZA NORTH TRENCH	19930708
127	2	WINDOWPANE	GLASS	PLAZA NORTH TRENCH	19930708
128	2	NAIL	IRON	PLAZA NORTH TRENCH	19930708
129	1	SHOE	LEATHER	PLAZA NORTH TRENCH	19930708
130	1	SHERD BOTTLE	GLASS	PLAZA NORTH TRENCH	19930708
131	1	SHERD BOTTLE	GLASS	PLAZA NORTH TRENCH	19930708
132	2	WINDOWPANE	GLASS	PLAZA NORTH TRENCH	19930708
133	1	WINDOWPANE PLATE	GLASS	PLAZA NORTH TRENCH	19930708
134	4	SHERD BOWL?	PORCELAIN	PLAZA NORTH TRENCH	19930708
135	1	NAIL SQUARE	IRON	PLAZA NORTH TRENCH	19930708
136	1	FEMUR ARTIODACTYLA	BONE	PLAZA NORTH TRENCH	19930708
137	1	LONG BONE MAMMALIA	BONE	PLAZA NORTH TRENCH	19930708
138	4	UNIDENTIFIED MAMMALIA	BONE	PLAZA NORTH TRENCH	19930708
139	2	UNIDENTIFIED MAMMALIA	BONE	PLAZA NORTH TRENCH	19930708
140	1	SCUTE ACIPENSER FULVESCENS	BONE	PLAZA NORTH TRENCH	19930708
141	2	SHERD UNIDENTIFIED	PORCELAIN	PLAZA NORTH TRENCH	19930708
142	1	SHERD CUP	PORCELAIN	PLAZA NORTH TRENCH	19930708
143	1	SHERD JAR	GLASS	PLAZA NORTH TRENCH	19930708
144	1	CHINKING	CLAY	PLAZA NORTH TRENCH	19930708
145	1	UNIDENTIFIED MAMMALIA	BONE	PLAZA NORTH TRENCH	19930708
146	1	SCRAP	BARCLITE	PLAZA NORTH TRENCH	19930708
147	2	NAIL SQUARE	IRON	PLAZA NORTH TRENCH	19930708
148	1	SHERD BOTTLE	GLASS	PLAZA NORTH TRENCH	19930708
149	1	SHERD BOTTLE	GLASS	PLAZA NORTH TRENCH	19930708
150	4	SHERD BOTTLE	GLASS	PLAZA NORTH TRENCH	19930708

SPECIMEN CATALOGUE RECORD

Site: DLG-33:93B THE FORKS Area: RED RIVER

Client: THE FORKS RENEWAL CORP.

Acc. No.:

Cat. # Qty Object Name / Object Type Material / Cultural Phase Location / Unit Coll. Date

Cat. #	Qty	Object Name / Object Type	Material / Cultural Phase	Location / Unit	Coll. Date
151	1	SHERD BOTTLE	GLASS INDUSTRIAL	PLAZA NORTH TRENCH	19930708
152	2	SHERD BOTTLE	GLASS INDUSTRIAL	PLAZA NORTH TRENCH	19930708
153	1	WINDOWPANE PLATE	GLASS INDUSTRIAL	PLAZA NORTH TRENCH	19930708
154	2	WINDOWPANE	GLASS INDUSTRIAL	PLAZA NORTH TRENCH	19930708
155	1	GAUGE	GLASS INDUSTRIAL	PLAZA NORTH TRENCH	19930708
156	1	SHERD CROCK	STONEWARE INDUSTRIAL	PLAZA NORTH TRENCH	19930708
157	1	SHERD CUP	PORCELAIN INDUSTRIAL	PLAZA NORTH TRENCH	19930708
158	1	SHERD BOWL?	PORCELAIN INDUSTRIAL	PLAZA NORTH TRENCH	19930708
159	1	SHERD PLATE?/SAUCER?	PORCELAIN INDUSTRIAL	PLAZA NORTH TRENCH	19930708
160	5	SHERD UNIDENTIFIED	PORCELAIN INDUSTRIAL	PLAZA NORTH TRENCH	19930708
161	1		HOMESTEAD	PLAZA NORTH TRENCH	19930708
162	1	MOLAR ARTIODACTYLA	BONE HOMESTEAD	PLAZA NORTH TRENCH	19930708
163	1	SKULL MAMMALIA	BONE HOMESTEAD	PLAZA NORTH TRENCH	19930708
164	1	FEMUR ARTIODACTYLA	BONE HOMESTEAD	PLAZA NORTH TRENCH	19930708
165	1	LONG BONE MAMMALIA	BONE HOMESTEAD	PLAZA NORTH TRENCH	19930708
166	2	RIB MAMMALIA	BONE HOMESTEAD	PLAZA NORTH TRENCH	19930708
167	1	SHERD BOTTLE	GLASS INDUSTRIAL	PLAZA NORTH TRENCH	19930708
168	1	LANTERN	GLASS INDUSTRIAL	PLAZA NORTH TRENCH	19930708
169	3	WINDOWPANE	GLASS INDUSTRIAL	PLAZA NORTH TRENCH	19930708
170	1	SHERD BOTTLE	GLASS INDUSTRIAL	PLAZA NORTH TRENCH	19930708
171	1	SHERD BOTTLE	GLASS INDUSTRIAL	PLAZA NORTH TRENCH	19930708
172	1	SHERD BOTTLE	GLASS INDUSTRIAL	PLAZA NORTH TRENCH	19930708
173	1	SHERD BOTTLE	GLASS INDUSTRIAL	PLAZA NORTH TRENCH	19930708
174	1	SHERD CUP	PORCELAIN INDUSTRIAL	PLAZA NORTH TRENCH	19930708
175	1	SHERD BOWL?/CUP?	PORCELAIN INDUSTRIAL	PLAZA NORTH TRENCH	19930708

SPECIMEN CATALOGUE RECORD

Site: DLG-33:93B THE FORKS

Area: RED RIVER

Client: THE FORKS RENEWAL CORP.

Acc. No.:

Cat. # Qty Object Name / Object Type Material / Cultural Phase Location / Unit Coll. Date

Cat. #	Qty	Object Name / Object Type	Material / Cultural Phase	Location / Unit	Coll. Date
176	1	SHERD PLATE?/SAUCER?	INDUSTRIAL	PLAZA NORTH TRENCH	19930708
177	1	SHERD BOWL	INDUSTRIAL	PLAZA NORTH TRENCH	19930708
178	1	SCRAP	IRON	PLAZA NORTH TRENCH	19930708
179	1	PIPE	KADLIN	PLAZA NORTH TRENCH	19930708
180	1	IRON NAIL	INDUSTRIAL	PLAZA NORTH TRENCH	19930708
181	1	SEWER TILE	TERKACOTA	PLAZA NORTH TRENCH	19930708
182	2	SHERD BOWL? / CUP?	INDUSTRIAL	PLAZA NORTH TRENCH	19930708
183	3	SHERD SAUCER	INDUSTRIAL	PLAZA NORTH TRENCH	19930708
184	4	SHERD BOWL	INDUSTRIAL	PLAZA NORTH TRENCH	19930708
185	1	PHALANX	INDUSTRIAL	PLAZA NORTH TRENCH	19930708
186	1	VERTEBRA	INDUSTRIAL	PLAZA NORTH TRENCH	19930708
187	1	RIB	INDUSTRIAL	PLAZA NORTH TRENCH	19930708
188	1	RIB	INDUSTRIAL	PLAZA NORTH TRENCH	19930708
189	1	LONG BONE	INDUSTRIAL	PLAZA NORTH TRENCH	19930708
190	2	LONG BONE	INDUSTRIAL	PLAZA NORTH TRENCH	19930708
191	11	CARPUS?/TARSUS?	INDUSTRIAL	PLAZA NORTH TRENCH	19930708
192	1	SCAPULA	INDUSTRIAL	PLAZA NORTH TRENCH	19930708
193	1	IRON NAIL	INDUSTRIAL	PLAZA NORTH TRENCH	19930708
194	1	SHERD BOTTLE	INDUSTRIAL	PLAZA NORTH TRENCH	19930708
195	1	SHERD SAUCER	INDUSTRIAL	PLAZA NORTH TRENCH	19930708
196	1	SHERD BOWL	INDUSTRIAL	PLAZA NORTH TRENCH	19930708
197	3	SHERD UNIDENTIFIED	INDUSTRIAL	PLAZA NORTH TRENCH	19930708
198	3	SHERD GLASS JAR	INDUSTRIAL	PLAZA NORTH TRENCH	19930708
199	1	BATHROOM FIXTURE	INDUSTRIAL	PLAZA NORTH TRENCH	19930708
200	1	SCRAP	INDUSTRIAL	PLAZA NORTH TRENCH	19930708

## SPECIMEN CATALOGUE RECORD

Site: DLLG-33:93B THE FORKS

Area: RED RIVER

Client: THE FORKS RENEWAL CORP.

Acc. No.:

Cat. #	Qty	Object Name / Object Type	Material / Cultural Phase	Location / Unit	Coll. Date
201	2	GAUGE	GLASS INDUSTRIAL	PLAZA WEST TRENCH	19930708
202	1	SHERD BOTTLE	GLASS INDUSTRIAL	PLAZA WEST TRENCH	19930708
203	1	SHERD BOTTLE	GLASS INDUSTRIAL	PLAZA WEST TRENCH	19930708
204	1	SHERD BOTTLE	GLASS INDUSTRIAL	PLAZA WEST TRENCH	19930708
205	42	WINDOWPANE	GLASS INDUSTRIAL	PLAZA WEST TRENCH	19930708
206	1	SHERD BOWL	GLASS INDUSTRIAL	PLAZA WEST TRENCH	19930708
207	1	WINDOWPANE	GLASS INDUSTRIAL	PLAZA WEST TRENCH	19930708
208	1	SCRAP	COPPER INDUSTRIAL	PLAZA WEST TRENCH	19930708
209	4	NAIL SQUARE	IRON INDUSTRIAL	PLAZA WEST TRENCH	19930708
210	1	VERTEBRA ARTIODACTYLA	BONE INDUSTRIAL	PLAZA WEST TRENCH	19930708
211	1	KNIFE	IRON INDUSTRIAL	PLAZA WEST TRENCH	19930708
212	1	SHERD BOTTLE	GLASS INDUSTRIAL	PLAZA WEST TRENCH	19930708
213	1	ULNA ARTIODACTYLA	BONE HOMESTEAD	PLAZA WEST TRENCH	19930708
214	1	RIB ARTIODACTYLA	BONE HOMESTEAD	PLAZA WEST TRENCH	19930708
215	1	COSTAL CARTILAGE MAMMALIA	BONE HOMESTEAD	PLAZA WEST TRENCH	19930708
216	1	VERTEBRA ARTIODACTYLA	BONE HOMESTEAD	PLAZA WEST TRENCH	19930708
217	1	LONG BONE MAMMALIA	BONE HOMESTEAD	PLAZA WEST TRENCH	19930708
218	11	RIB MAMMALIA	BONE HOMESTEAD	PLAZA WEST TRENCH	19930708
219	1	SHERD BOTTLE	GLASS INDUSTRIAL	PLAZA WEST TRENCH	19930708
220	2	SHERD JAR	GLASS INDUSTRIAL	PLAZA WEST TRENCH	19930708
221	4	SHERD CUP	PORCELAIN INDUSTRIAL	PLAZA WEST TRENCH	19930708
222	2	SHERD PLATE?/SAUCER?	PORCELAIN INDUSTRIAL	PLAZA WEST TRENCH	19930708
223	1	NAIL UNIDENTIFIED	IRON INDUSTRIAL	PLAZA WEST TRENCH	19930708
224	1	BUTTON SHANK	COPPER INDUSTRIAL	PLAZA WEST TRENCH	19930708
225	3	WINDOWPANE	GLASS INDUSTRIAL	PLAZA WEST TRENCH	19930708

## SPECIMEN CATALOGUE RECORD

Site: DLG-33:93B THE FORKSArea: RED RIVERClient: THE FORKS RENEWAL CORP.

Acc. No.:

Cat. #	Qty	Object Name / Object Type	Material / Cultural Phase	Location / Unit	Coll. Date
226	1	SHERD FLOWERPOT	TERRACOTTA INDUSTRIAL	PLAZA WEST TRENCH	19930708
227	2	VALVE UNIONIDAE	SHELL INDUSTRIAL	PLAZA WEST TRENCH	19930708
228	1	UNIDENTIFIED MAMMALIA	BONE INDUSTRIAL	PLAZA WEST TRENCH	19930708
229	7	SHERD SAUCER	PORCELAIN INDUSTRIAL	PLAZA WEST TRENCH	19930708
230	1	SHERD PLATE??/SAUCER?	PORCELAIN INDUSTRIAL	PLAZA WEST TRENCH	19930708
231	1	SHERD PLATE??/SAUCER?	PORCELAIN INDUSTRIAL	PLAZA WEST TRENCH	19930708
232	1	SHERD BOWL?	PORCELAIN INDUSTRIAL	PLAZA WEST TRENCH	19930708
233	12	SHERD BOWL?	PORCELAIN INDUSTRIAL	PLAZA WEST TRENCH	19930708
234	1	SHERD CUP	PORCELAIN INDUSTRIAL	PLAZA WEST TRENCH	19930708
235	4	SHERD UNIDENTIFIED	PORCELAIN INDUSTRIAL	PLAZA WEST TRENCH	19930708
236	1	PIPE	KAOLIN HOMESTEAD	PLAZA WEST TRENCH	19930708
237	1	VALVE UNIONIDAE	SHELL HOMESTEAD	PLAZA WEST TRENCH	19930708
238	1	VERTEBRA ARTIODACTYLA	BONE HOMESTEAD	PLAZA WEST TRENCH	19930708
239	1	TIBIA ARTIODACTYLA	BONE HOMESTEAD	PLAZA WEST TRENCH	19930708
240	1	RIB MAMMALIA	BONE HOMESTEAD	PLAZA WEST TRENCH	19930708
241	1	RIB MAMMALIA	BONE HOMESTEAD	PLAZA WEST TRENCH	19930708
242	2	LONG BONE MAMMALIA	BONE HOMESTEAD	PLAZA WEST TRENCH	19930708
243	1	SKULL MAMMALIA	BONE HOMESTEAD	PLAZA WEST TRENCH	19930708
244	3	UNIDENTIFIED MAMMALIA	BONE HOMESTEAD	PLAZA WEST TRENCH	19930708
245	1	LONG BONE MAMMALIA	BONE HOMESTEAD	PLAZA WEST TRENCH	19930708
246	1	PREOPERCULUM FISH	BONE HOMESTEAD	PLAZA WEST TRENCH	19930708
247	3	SHERD JUG	STONEWARE INDUSTRIAL	PLAZA WEST TRENCH	19930709
248	12	WINDOWPANE	GLASS INDUSTRIAL	PLAZA WEST TRENCH	19930709
249	1	INSULATOR	GLASS INDUSTRIAL	PLAZA WEST TRENCH	19930709
250	1	LANTERN	GLASS INDUSTRIAL	PLAZA WEST TRENCH	19930709

## SPECIMEN CATALOGUE RECORD

Site: DLG-33:93B THE FORKSArea: RED RIVERClient: THE FORKS RENEWAL CORP.

Acc. No.:

Cat. #	Qty	Object Name / Object Type	Material / Cultural Phase	Location / Unit	Coll. Date
251	2	SHERD JAR	GLASS INDUSTRIAL	PLAZA WEST TRENCH	19930709
252	3	SHERD BOTTLE	GLASS INDUSTRIAL	PLAZA WEST TRENCH	19930709
253	1	SHERD JAR?	GLASS INDUSTRIAL	PLAZA WEST TRENCH	19930709
254	2	SHERD BOTTLE	GLASS INDUSTRIAL	PLAZA WEST TRENCH	19930709
255	3	SHERD BOTTLE	GLASS INDUSTRIAL	PLAZA WEST TRENCH	19930709
256	2	SHERD BOTTLE	GLASS INDUSTRIAL	PLAZA WEST TRENCH	19930709
257	1	SHERD BOTTLE	GLASS INDUSTRIAL	PLAZA WEST TRENCH	19930709
258	1	SHERD BOTTLE	GLASS INDUSTRIAL	PLAZA WEST TRENCH	19930709
259	1	SHERD BOTTLE	GLASS INDUSTRIAL	PLAZA WEST TRENCH	19930709
260	1	SHERD BOTTLE	GLASS INDUSTRIAL	PLAZA WEST TRENCH	19930709
261	10	SHERD BOTTLE	GLASS INDUSTRIAL	PLAZA WEST TRENCH	19930709
262	2	SHERD JAR	GLASS INDUSTRIAL	PLAZA WEST TRENCH	19930709
263	2	SHERD PLATE	PORCELAIN INDUSTRIAL	PLAZA WEST TRENCH	19930709
264	8	SHERD PLATE?/SAUCER?	PORCELAIN INDUSTRIAL	PLAZA WEST TRENCH	19930709
265	3	SHERD PLATE?/SAUCER?	PORCELAIN INDUSTRIAL	PLAZA WEST TRENCH	19930709
266	1	INNOMINATE MAMMALIA	BONE INDUSTRIAL	PLAZA WEST TRENCH	19930709
267	1	SACRUM MAMMALIA	BONE INDUSTRIAL	PLAZA WEST TRENCH	19930709
268	1	FIBULA SUS SCROFA	BONE INDUSTRIAL	PLAZA WEST TRENCH	19930709
269	1	OPERCULUM FISH	BONE INDUSTRIAL	PLAZA WEST TRENCH	19930709
270	2	UNIDENTIFIED FISH	BONE INDUSTRIAL	PLAZA WEST TRENCH	19930709
271	1	PHALANX ARTIODACTYLA	BONE HOMESTEAD	PLAZA WEST TRENCH	19930709
272	3	RIB MAMMALIA	BONE HOMESTEAD	PLAZA WEST TRENCH	19930709
273	1	BATHROOM FIXTURE	PORCELAIN INDUSTRIAL	PLAZA WEST TRENCH	19930709
274	1	SHERD SAUCER	PORCELAIN INDUSTRIAL	PLAZA WEST TRENCH	19930709
275	1	SHERD BOTTLE	GLASS INDUSTRIAL	PLAZA WEST TRENCH	19930709

## SPECIMEN CATALOGUE RECORD

Site: DLLG-33:93B THE FORKS

Area: RED RIVER

Client: THE FORKS RENEWAL CORP.

Acc. No.:

Cat. #	Qty	Object Name / Object Type	Material / Cultural Phase	Location / Unit	Coll. Date
276	2	SHERD BOTTLE	GLASS INDUSTRIAL	PLAZA WEST TRENCH	19930709
277	5	SHERD BOTTLE	GLASS INDUSTRIAL	PLAZA WEST TRENCH	19930709
278	3	WINDOWPANE	GLASS INDUSTRIAL	PLAZA WEST TRENCH	19930709
279	1	WINDOWPANE PLATE	GLASS INDUSTRIAL	PLAZA WEST TRENCH	19930709
280	1	WINDOWPANE PLATE	GLASS INDUSTRIAL	PLAZA WEST TRENCH	19930709
281	3	WINDOWPANE	GLASS INDUSTRIAL	PLAZA WEST TRENCH	19930709
282	1	NAIL SQUARE	IRON INDUSTRIAL	PLAZA WEST TRENCH	19930709
283	3	SHERD BOTTLE	GLASS INDUSTRIAL	PLAZA WEST TRENCH	19930709
284	1	SHERD BOWL	PORCELAIN INDUSTRIAL	PLAZA WEST TRENCH	19930709
285	1	SHERD UNIDENTIFIED	PORCELAIN INDUSTRIAL	PLAZA WEST TRENCH	19930709
286	1	INNOMINATE MAMMALIA	BONE INDUSTRIAL	PLAZA WEST TRENCH	19930709
287	1	FEMUR MAMMALIA	BONE INDUSTRIAL	PLAZA WEST TRENCH	19930709
288	2	WINDOWPANE	GLASS INDUSTRIAL	PLAZA WEST TRENCH	19930709
289	1	SHERD BOTTLE	GLASS INDUSTRIAL	PLAZA WEST TRENCH	19930709
290	1	SHERD BOTTLE	GLASS INDUSTRIAL	PLAZA WEST TRENCH	19930709
291	2	WINDOWPANE	GLASS INDUSTRIAL	PLAZA WEST TRENCH	19930709
292	3	SHERD BOTTLE	GLASS INDUSTRIAL	PLAZA WEST TRENCH	19930709
293	1	SHERD BOTTLE	GLASS INDUSTRIAL	PLAZA WEST TRENCH	19930709
294	1	SHERD BOTTLE	GLASS INDUSTRIAL	PLAZA WEST TRENCH	19930709
295	1	GAUGE	GLASS INDUSTRIAL	PLAZA WEST TRENCH	19930709
296	1	O-RING	PLASTIC INDUSTRIAL	PLAZA WEST TRENCH	19930709
297	1	NAIL UNIDENTIFIED	IRON INDUSTRIAL	PLAZA WEST TRENCH	19930709
298	1	SHERD BOTTLE	GLASS INDUSTRIAL	PLAZA WEST TRENCH	19930709
299	1	SHERD PLATE	PORCELAIN INDUSTRIAL	PLAZA WEST TRENCH	19930709
300	2	SHERD PLATE?/SAUCER?	PORCELAIN INDUSTRIAL	PLAZA WEST TRENCH	19930709

## SPECIMEN CATALOGUE RECORD

Site: DLG-33:93B THE FORKSArea: RED RIVERClient: THE FORKS RENEWAL CORP.

Acc. No.: \_\_\_\_\_

Cat. #	Qty	Object Name / Object Type	Material / Cultural Phase	Location / Unit	Coll. Date
301	1	RIB MAMMALIA	BONE INDUSTRIAL	PLAZA WEST TRENCH	19930709
302	1	LONG BONE MAMMALIA	BONE INDUSTRIAL	PLAZA WEST TRENCH	19930709
303	1	LONG BONE MAMMALIA	BONE HOMESTEAD	PLAZA WEST TRENCH	19930709
304	2	UNIDENTIFIED MAMMALIA	BONE HOMESTEAD	PLAZA WEST TRENCH	19930709
305	1	NAIL UNIDENTIFIED	IRON HOMESTEAD	PLAZA WEST TRENCH	19930709
306	2	SHERD PLATE	PORCELAIN HOMESTEAD	PLAZA WEST TRENCH	19930709
307	4	INSULATOR	GLASS INDUSTRIAL	PLAZA WEST TRENCH	19930709
308	2	WINDOWPANE PLATE	GLASS INDUSTRIAL	PLAZA WEST TRENCH	19930709
309	18	WINDOWPANE	GLASS INDUSTRIAL	PLAZA WEST TRENCH	19930709
310	3	SHERD JAR	GLASS INDUSTRIAL	PLAZA WEST TRENCH	19930709
311	1	SHERD JUG	STONWARE INDUSTRIAL	PLAZA WEST TRENCH	19930709
312	2	SHERD CROCK	STONWARE INDUSTRIAL	PLAZA WEST TRENCH	19930709
313	1	SHERD SAUCER	PORCELAIN INDUSTRIAL	PLAZA WEST TRENCH	19930709
314	3	SHERD BOTTLE	GLASS INDUSTRIAL	PLAZA WEST TRENCH	19930709
315	3	SHERD BOTTLE	GLASS INDUSTRIAL	PLAZA WEST TRENCH	19930709
316	1	SHERD BOTTLE	GLASS INDUSTRIAL	PLAZA WEST TRENCH	19930709
317	1	BOTTLE BOTTLE	GLASS INDUSTRIAL	PLAZA WEST TRENCH	19930709
318	1	SHERD BOTTLE	GLASS INDUSTRIAL	PLAZA WEST TRENCH	19930709
319	2	SHERD BOTTLE	GLASS INDUSTRIAL	PLAZA WEST TRENCH	19930709
320	1	SHERD BOTTLE	GLASS INDUSTRIAL	PLAZA WEST TRENCH	19930709
321	1	SHERD BOTTLE	GLASS INDUSTRIAL	PLAZA WEST TRENCH	19930709
322	1	SHERD BOTTLE	GLASS INDUSTRIAL	PLAZA WEST TRENCH	19930709
323	1	SHERD BOTTLE	GLASS INDUSTRIAL	PLAZA WEST TRENCH	19930709
324	4	SHERD BOTTLE	GLASS INDUSTRIAL	PLAZA WEST TRENCH	19930709
325	2	SHERD BOTTLE	GLASS INDUSTRIAL	PLAZA WEST TRENCH	19930709



SPECIMEN CATALOGUE RECORD

Site: DLG-33:93B THE FORKS

Area: RED RIVER

Client: THE FORKS RENEWAL CORP.

Acc. No.:

Cat. # Qty Object Name / Object Type Material / Cultural Phase Location / Unit Coll. Date

19930709	PLAZA WEST TRENCH	IRON	INDUSTRIAL	1	STRAP	326
19930709	PLAZA WEST TRENCH	GLASS	INDUSTRIAL	1	SHERD BOTTLE	327
19930709	PLAZA WEST TRENCH	GLASS	INDUSTRIAL	1	SHERD BOTTLE	328
19930709	PLAZA WEST TRENCH	GLASS	INDUSTRIAL	2	SHERD BOTTLE	329
19930709	PLAZA WEST TRENCH	POCELAIN	INDUSTRIAL	1	SHERD UNIDENTIFIED	330
19930709	PLAZA WEST TRENCH	BONE	INDUSTRIAL	1	DENTARY; ANGULAR ICTALURUS	331
19930709	PLAZA WEST TRENCH	BONE	INDUSTRIAL	1	DORSAL SPINE ICTALURUS	332
19930709	PLAZA WEST TRENCH	BONE	INDUSTRIAL	1	CARPUS ARTIODACTYLA	333
19930709	PLAZA WEST TRENCH	BONE	INDUSTRIAL	5	LONG BONE MAMMALIA	334
19930709	PLAZA WEST TRENCH	BONE	INDUSTRIAL	8	UNIDENTIFIED MAMMALIA	335
19930709	PLAZA WEST TRENCH	BONE	INDUSTRIAL	2	UNIDENTIFIED MAMMALIA	336
19930708	PLAZA WEST TRENCH	GLASS	INDUSTRIAL	2	SHERD BOTTLE	337

SPECIMEN CATALOGUE RECORD

Site: DLG-33:93D THE FORKS

Area: RED RIVER

Client: CHILDREN'S MUSEUM

Acc. No.:

Cat. # Qty Object Name / Object Type Material / Cultural Phase Location / Unit Coll. Date

Cat. #	Qty	Object Name / Object Type	Material / Cultural Phase	Location / Unit	Coll. Date
42	7	RIB	BONE	MUSEUM SERVICES	19930809
43	1	VERTEBRA	BONE	MUSEUM SERVICES	19930809
44	1	ULNA	BONE	MUSEUM SERVICES	19930809
45	1	PHALANX	BONE	MUSEUM SERVICES	19930809
46	1	PHALANX	BONE	MUSEUM SERVICES	19930809
47	2	SESAMOID	BONE	MUSEUM SERVICES	19930809
48	2	PHALANX	BONE	MUSEUM SERVICES	19930809
49	1	CARPUS?/TARSUS?	BONE	MUSEUM SERVICES	19930809
50	51	UNIDENTIFIED	BONE	MUSEUM SERVICES	19930809
51	1	METACARPAL	BONE	MUSEUM SERVICES	19930809
52	4	STERNBRA	BONE	MUSEUM SERVICES	19930809
53	3	SACRUM	BONE	MUSEUM SERVICES	19930809
54	33	COSTAL CARTILAGE	BONE	MUSEUM SERVICES	19930809
55	36	RIB	BONE	MUSEUM SERVICES	19930809